

**tyco**

**KTM**

#### Features

- Superior valve design at a competitive price.
- Designed to meet the highest manufacturing standards.
- ZERO leakage with standard E-Seat.
- Pure white E-Seat relieves concern over product contamination.
- Positive alignment of split body provides maximum protection against line stresses and thermal distortion.
- Fire-safe design tested to API 607.
- Secondary fire-safe metal to metal seat is standard.
- Blowout-proof stem.
- Static electricity grounding device.
- Sphericity tolerance of the balls,  $\pm 0.0008$ ", and a 4 RMS surface finish are unsurpassed.
- Reinforced PTFE bearing and packing rings reduce friction.
- Lower operating torque for ease of operation and reduced actuator cost.
- Secondary fire-safe metal-to-metal seat is standard.
- Automatic cavity pressure relief
- Positive position indication.
- Meets NACE MR0175 for sulfide cracking resistance.
- Locking device capable.

#### Technical data

Size range : EO100 Full bore  
1/2" through 8"

: EO800 Reduced bore  
3" through 10"

Standards : API 6D and 598

: ANSI B16.5, B16.10 and  
B16.34

: Firesafe approved;  
API 607, RP6F, 6FA,  
BS5146, OCMA FSV-1



#### Materials of Construction

Body : Carbon Steel (A216, WCB)  
: 316 SS (CF8M)

Ball : 316 SS (CF8M)

Stem : 316 SS

Seat : PTFE/PFA Copolymer

Packing : PTFE

Valve Class : 150 and 300

Test pressure per API 6D

: Shell (Hydrostatic)  
Class 150, 425 psig (30 kgf/cm<sup>2</sup>)  
Class 300, 1100 psig (77 kgf/cm<sup>2</sup>)

: Seat  
(Hydrostatic) (Air)  
Class 150, 300 psig 80 psig  
(21 kgf/cm<sup>2</sup>) (6 kgf/cm<sup>2</sup>)  
Class 300, 800 psig 80 psig  
(56 kgf/cm<sup>2</sup>) (6 kgf/cm<sup>2</sup>)

#### General applications

- Pulp and Paper
- Reactive Monomers
- Oil and Gas Production
- Steam
- Hot Gases
- Fire-safe and Flammables

**Total Flow Control Solutions**

Tyco reserves the right to change product design and specifications without notice. Copyright © 2002 by Tyco International Ltd.

KTMMC-0094-US-0208

## KTM Omni I Split Body Floating Ball Valve

### EO100 Full Bore and EO800 Reduced Bore

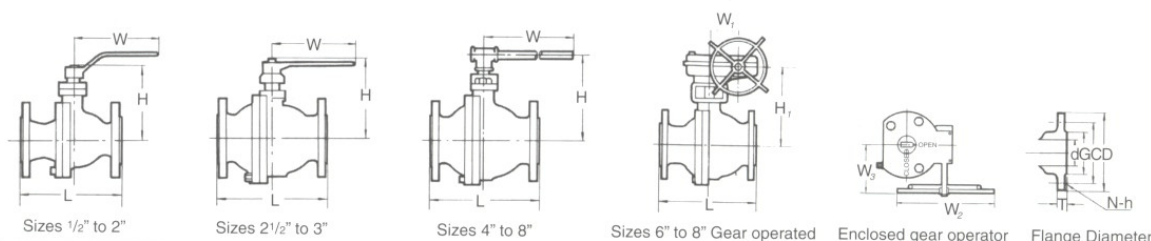

#### 150 lb. Class Dimensions and Weights

EO100										EO800										150 Lb. Flange					
Valve Size (d)	Bore	L	H	H <sub>1</sub>	W	W <sub>1</sub>	W <sub>2</sub>	W <sub>3</sub>	Wt. Lb.	(d)	Bore	L	H	H <sub>1</sub>	W	W <sub>1</sub>	W <sub>2</sub>	W <sub>3</sub>	Wt. Lb.	D	C	G	T	(N)	h
1/2"	0.50	4.25	2.25	—	5.13	—	—	—	5	—	—	—	—	—	—	—	—	—	—	3.50	2.38	1.38	0.38	(4)	5/8
3/4"	0.75	4.63	2.50	—	5.13	—	—	—	6.5	—	—	—	—	—	—	—	—	—	—	3.88	2.75	1.64	0.41	(4)	5/8
1"	1.00	5.00	3.00	—	6.25	—	—	—	10	—	—	—	—	—	—	—	—	—	—	4.25	3.13	2.00	0.44	(4)	5/8
1 1/2"	1.50	6.50	3.75	—	9.50	—	—	—	17	—	—	—	—	—	—	—	—	—	—	5.00	3.88	2.88	0.56	(4)	5/8
2"	2.00	7.00	4.25	—	9.50	—	—	—	23	—	—	—	—	—	—	—	—	—	—	6.00	4.75	3.63	0.63	(4)	3/4
2 1/2"	2.50	7.50	5.50	—	15.75	—	—	—	42	—	—	—	—	—	—	—	—	—	—	7.00	5.50	4.13	0.69	(4)	3/4
3"	3.00	8.00	6.00	—	15.75	—	—	—	51	2.50	8.00	5.50	—	15.75	—	—	—	—	42	7.50	6.00	5.00	0.75	(4)	3/4
4"	4.00	9.00	7.00	—	27.50	—	—	—	74	3.00	9.00	6.00	—	15.75	—	—	—	—	70	9.00	7.50	6.19	0.94	(8)	3/4
6"	6.00	15.00	10.75	11.50	43.25	3.38	17.75	9.50	151	5.00	10.50	10.00	10.75	43.25	3.38	17.75	9.50	121	11.00	9.50	8.50	1.00	(8)	7/8	
8"	8.00	18.00	13.50	15.75	59.00	4.56	23.38	13.75	238	6.00	11.50	10.75	11.50	43.25	3.38	17.75	9.50	182	13.50	11.75	10.63	1.13	(8)	7/8	
10"	—	—	—	—	—	—	—	—	—	8.00	13.50	13.50	15.75	59.00	4.56	23.38	—	267	16.00	14.25	12.75	1.19	(12)	1	

Weights for 6", 8" and 10" are lever operated valves. For gear operated, add 30 lbs. for 6" EO100 or 8" EO800 and 55 lbs. for 8" EO100 or 10" EO800.

#### 300 lb. Class Dimensions and Weights

EO100										EO800										150 Lb. Flange					
Valve Size (d)	Bore	L	H	H <sub>1</sub>	W	W <sub>1</sub>	W <sub>2</sub>	W <sub>3</sub>	Wt. Lb.	(d)	Bore	L	H	H <sub>1</sub>	W	W <sub>1</sub>	W <sub>2</sub>	W <sub>3</sub>	Wt. Lb.	D	C	G	T	(N)	h
1/2"	0.50	5.50	2.25	—	5.13	—	—	—	5.5	—	—	—	—	—	—	—	—	—	—	3.75	2.63	1.39	0.56	(4)	5/8
3/4"	0.75	6.00	2.50	—	5.13	—	—	—	7	—	—	—	—	—	—	—	—	—	—	4.63	3.25	1.64	0.63	(4)	3/4
1"	1.00	6.50	3.00	—	6.25	—	—	—	11	—	—	—	—	—	—	—	—	—	—	4.88	3.50	2.00	0.69	(4)	3/4
1 1/2"	1.50	7.50	3.75	—	9.5	—	—	—	24	—	—	—	—	—	—	—	—	—	—	6.13	4.50	2.88	0.81	(4)	7/8
2"	2.00	8.50	4.25	—	9.5	—	—	—	33	—	—	—	—	—	—	—	—	—	—	6.50	5.00	3.63	0.88	(8)	3/4
2 1/2"	2.50	9.50	5.50	—	15.75	—	—	—	52	—	—	—	—	—	—	—	—	—	—	7.50	5.88	4.13	1.00	(8)	7/8
3"	3.00	11.13	6.00	—	15.75	—	—	—	79	2.50	11.13	5.50	—	15.75	—	—	—	—	75	8.25	6.63	5.00	1.13	(8)	7/8
4"	4.00	12.00	7.00	—	27.5	—	—	—	91	3.00	12.00	6.00	—	15.75	—	—	—	—	84	10.00	7.88	6.19	1.25	(8)	7/8
6"	6.00	15.88	10.75	11.50	43.25	3.38	17.75	9.50	233	5.00	15.88	10.00	10.75	43.25	3.38	17.75	9.50	148	12.50	10.63	8.50	1.44	(12)	7/8	
8"	8.00	19.75	13.50	15.75	59.00	4.56	23.38	13.75	267	6.00	16.50	10.75	11.50	43.25	3.38	17.75	9.50	208	15.00	13.00	10.63	1.63	(12)	1	
10"	—	—	—	—	—	—	—	—	—	8.00	18.00	13.50	15.75	59.00	4.56	23.38	—	317	17.50	15.25	12.75	1.88	(16)	1 1/8	

Weights for 6", 8" and 10" are lever operated valves. For gear operated, add 30 lbs. for 6" EO100 or 8" EO800 and 55 lbs. for 8" EO100 or 10" EO800.

#### Notes

- Model EO800 6" through 10" face-to-face dimensions are based on API 6D short pattern.
- API 6D stipulates face-to-face dimensions for sizes 2" and over.
- The face-to-face dimensions up to 1 1/2" are based on the following standards:  
 Class 150 1/2" to 1 1/2" : ANSI 16.10 #150 Gate Valve  
 Class 300 1/2" to 1" : MSS DS-13 #300 Gate Valve  
 Class 300 1/2" to 1 1/2" : ANSI B16.10 #300 Gate Valve
- Lever handle standard up to 8". Gear operators are available. KTM furnishes a lever handle for sizes up to 10" due to low operating torque. Gear operators are available at user's option.
- KTM ball valves comply with one or more of the following standard specifications as to pressure, temperature ratings and dimensions:  
 ANSI B2.1 Pipe Threads  
 ANSI B16.5 Steel Pipe Flanges  
 ANSI B16.10 Face-to-Face Dimensions  
 ANSI B16.34 Valves-Flanged, threaded and welded end

Facility Phone: 713-744-4532

**tyco** Valves & Controls

www.tycovalves.com

#### C<sub>v</sub> Value, Full and Reduced Port

Valve Size	Full EO100	Reduced EO800
1/2"	26	—
3/4"	50	—
1"	94	—
1 1/2"	260	—
2"	480	—
2 1/2"	750	—
3"	1300	420
4"	2300	770
6"	5400	1800
8"	10000	2500
10"	—	4500

The data presented in this bulletin is for general information only. Manufacturer is not responsible for acceptability of these products in relation to system requirements. Patents and Patents Pending in U.S. and foreign countries. All rights reserved. Printed in U.S.A. Tyco reserves the right to change product design and specifications without notice. © Copyright 2002.

Tyco reserves the right to change product design and specifications without notice. Copyright © 2002 by Tyco International Ltd.

KTMCM-0094  
2