

BERIC DAVIS COMPANIES INTERNATIONAL, LTD.

Connecting Business Worldwide!



WWW.BERICVALVES.COM

**FORGED
STEEL
TECHNICAL DATA**

Figure Number Chart

Valve Style		End Connection		Size		Class	
501	BB Gate	B(SCH)	Butt Weld	1	¼	1	#150
502	BB Globe	F	Flanged	2	¾	3	#300
503	BB Piston Check	G	Flat Face Flange	3	½	6	#600
504	BB Swing Check	H	MNPT X FNPT	4	¾	8	#800
505	WB Gate	J	MNPT X FSW	5	1	9	#1500
506	WB Globe	K	MSW X FNPT	6	1 ¼	0	#2500
507	WB Piston Check	L	MSW X FSW	7	1 ½	A	#900
508	WB Swing Check	R	RTJ	8	2	B	#1690
509	BB Y-Pattern Globe	S	Socket Weld			C	#2690
510	BB Y-Pattern Check	T	NPT				
511	FP BB Gate	W	FNPT X SW				
512	WB Y-Pattern Globe	X	SW X FNPT				
513	WB Y-Pattern Check	Y	RMSW X FNPT				
514	FP BB Swing Check	Z	RMSW X FSW				
515	FP WB Gate						
516	FP WB Globe						
517	FP WB Piston Check						
518	FP WB Swing Check						
522	FP BB Globe						
523	FP BB Piston Check						
530	BB Ball Check						
531	FP BB Ball Check						
532	WB Ball Check						
533	FP WB Ball Check						
552	WB Y-Pattern Stop/Check						
561	Pressure Seal Gate						
562	Pressure Seal Globe						
563	Pressure Seal Piston Check						

* More than one option may be used in combination.

Notes:

1. Not all options are available in combinations. Please consult the factory. Minimum quantities may apply to certain materials or trim configurations.
2. Beric trim number corresponds to the equivalent API 602 trim designation.

FIGURE NUMBER EXAMPLE: 501S48A08N

Figure Number Chart (cont'd)

Material		Trim	Options *	
A	A105N	01 (410)	A	316 Stn. Stl. Trim
B	A350 LF2 (default CL2)	02 (304)	B	B7M Bolting
C	A182 F5	03 (310)	C	Chain Operated
D	A182 F9	04	C1,2...	Material Class Option
E	A182 F11	05 (410)	D	Extended Bonnet
F	A182 F22	06	E	17-4 ph Stem
G	A182 F304/304L	07	E1	NPS 2 body, flange with 3/4 inch inlet and outlet ports
H	A182 F316/316L	08 (410)	F	Industrial Gas Cleaned
J	A182 F321	09	G	Garlock EVSP Packing
K	A182 F52	10 (316)	H	Hastelloy C Stem
M	A182 F347	11	J	High Temp Packing & Gasket
N	A350-LF3	12 (316)	K	Live Loaded
P	A182 F12	13	L	Lock Bonnet
Q	A182 P91	14	L1	CSC, gate & globe
R	A182 F51	15 (304)	M	Position Indicator
S	A182 F316H	16 (316)	N	NACE
T	A182 F317/F317L	17 (347/FHF)	O	Oxygen Cleaned
U	A182 F347H	18	P	125rms Flat Faced Flange
4	MONEL 400	19 (F51)	Q	Other, specify
		26 (316H)FHF	R	L7M Bolting
		27 (317) HHF	S	B8M Bolting
		32 (304) HHF	T	TFE Packing, 316/TFE Gasket
			U	316/TFE Gasket Only
			V	Vacuum Service
			W	316ss Bellow Seal
			W1	321ss Bellow Seal
			X	Nipple Extensions
			Y	Cryogenic Service
			Z	Mounting Plate
			A2	HF Alkylation Service
			A3	RPTFE Seat

FORGED STEEL VALVES: GATE, GLOBE, & CHECK

ANSI Class:

800 For Threaded And Socket Weld Ends
150, 300, & 600 For Raised Face Flanged
Class 1500, 1690, 2500, & 2690 Also Available

Materials:

ASTM A 105N – Carbon Steel
ASTM A 350 Gr. LF2 – Low Temperature Carbon Steel
ASTM A 182 Gr. 316/316L – Stainless Steel
ASTM A 182 Gr. F5, F9, F11, F22 – Alloy Steel

Specifications:

Designed To The Applicable Requirements Of:
API 602, ASME B16.34, BS 5352, & MSS SP-118

Tested In Accordance With: API 598 & ASME B16.34

Markings Per MSS SP-25

End Connections:

Screwed Ends (NPT) to: ASME B1.20.1
Socket Weld Ends to: ASME B16.11
Butt Welding Ends to: ASME B16.25
Flanged Ends to: ASME B16.5 & B16.10



Gate Valve Standard Port, Bolted Bonnet Forged Steel

501 SERIES

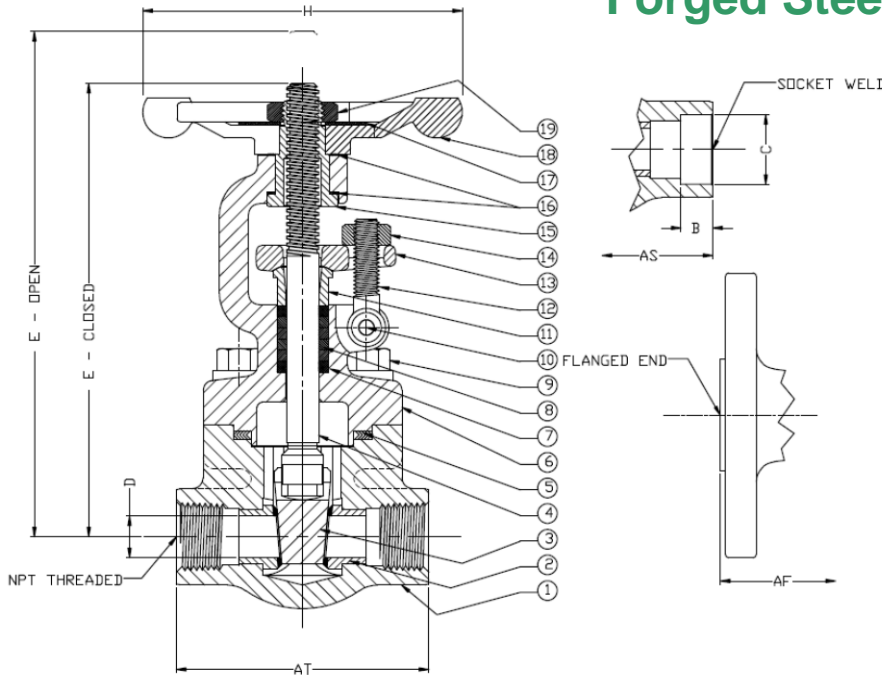

STANDARDS

DESIGN:

API 602
ASME B16.34

TESTING:

API 598

PRESSURE CLASS:

NPT & SW – 800
FLANGED – 150,300,600

CONNECTIONS:

NPT – ASME B1.20.1
SW - ASME B16.11
FLANGED – ASME B16.5
ASME B16.10

		MATERIAL LIST						
NO.	Part Name	A105	LF2	F5	F9	F11	F22	F316/F316L
1	Body	A105N	A350-LF2	A182-F5	A182-F9	A182-F11	A182-F22	A182-F316/F316L
2	Seat Ring	A276-410/CoCr-A						A276-316/CoCr-A
3	Gate	A276-420						A276-316
4	Stem	A276-410						A276-316
5	Gasket	Spiral Wound 304/Graphite						316/Graphite
6	Bonnet	A105N	A350-LF2	A182-F5	A182-F9	A182-F11	A182-F22	A182-F316/F316L
7	Wiper Ring	Braided Graphite						
8	Packing	Die Formed Graphite						
9	Body Bolt	A193-B7	A320-L7	A193-B16				A193-B8M
10	Eyebolt Pin	A276-410						A276-316
11	Gland	A276-420						A276-316
12	Eyebolt	A193-B7	A320-L7	A193-B16				A193-B8M
13	Gland Plate	A105						A182-F316
14	Gland Nut	A194-2H	A194-4	A194-7				A194-8M
15	Op Nut	A276-410						A276-410
16	Washer	A276-410						
17	Nameplate	Aluminum						
18	Handwheel	A197						
19	Handwheel Nut	A194-2H						A194-8

		DIMENSIONS AND WEIGHTS										WGT.				
SIZE		AT	AS	AF-150	AF-300	AF-600	B (Min)	C	D (Min)	EO	EC	H	150	300	600	800
1/2	Inch	3.11	3.11	4.25	5.51	6.50	0.37	0.87	0.37	6.20	5.51	3.94	5.95	7.72	8.60	4.41
	mm	79.0	79.0	108.0	140.0	165.0	9.50	22.0	9.50	158.0	140.0	100.0	2.70	3.50	3.90	2.00
3/4	Inch	3.62	3.62	4.61	5.98	7.48	0.49	1.08	0.51	6.20	5.59	3.94	7.50	10.1	11.9	4.85
	mm	92.0	92.0	117.0	152.0	190.0	12.5	27.4	13.0	158.0	142.0	100.0	3.40	4.60	5.40	2.20
1	Inch	4.37	4.37	5.00	6.50	8.50	0.49	1.34	0.71	7.28	6.50	4.72	11.7	14.8	16.5	7.72
	mm	111.0	111.0	127.0	165.0	216.0	12.5	34.1	18.0	185.0	165.0	120.0	5.30	6.70	7.50	3.50
1-1/4	Inch	4.72	4.72	5.51	7.01	9.02	0.49	1.69	0.94	8.90	7.87	6.30	17.0	21.2	24.9	12.1
	mm	120.0	120.0	140.0	178.0	229.0	12.5	42.9	24.0	226.0	200.0	160.0	7.70	9.60	11.3	5.50
1-1/2	Inch	4.72	4.72	6.50	7.48	9.49	0.49	1.93	1.14	9.49	8.31	6.30	20.9	26.7	32.0	14.1
	mm	120.0	120.0	165.0	190.0	241.0	12.5	49.0	29.0	241.0	211.0	160.0	9.50	12.1	14.5	6.40
2	Inch	5.51	5.51	7.01	8.50	11.5	0.63	2.42	1.44	10.8	9.25	8.66	30.9	37.7	45.9	20.5
	mm	140.0	140.0	178.0	216.0	292.0	16.0	61.5	36.5	275.0	235.0	220.0	14.0	17.1	20.8	9.30

(713) 673-2073 – Fax (713) 673-4641 - Toll Free (866) GO-BERIC (462-3742)

www.bericvalves.com

Globe Valve Standard Port, Bolted Bonnet Forged Steel

502 SERIES

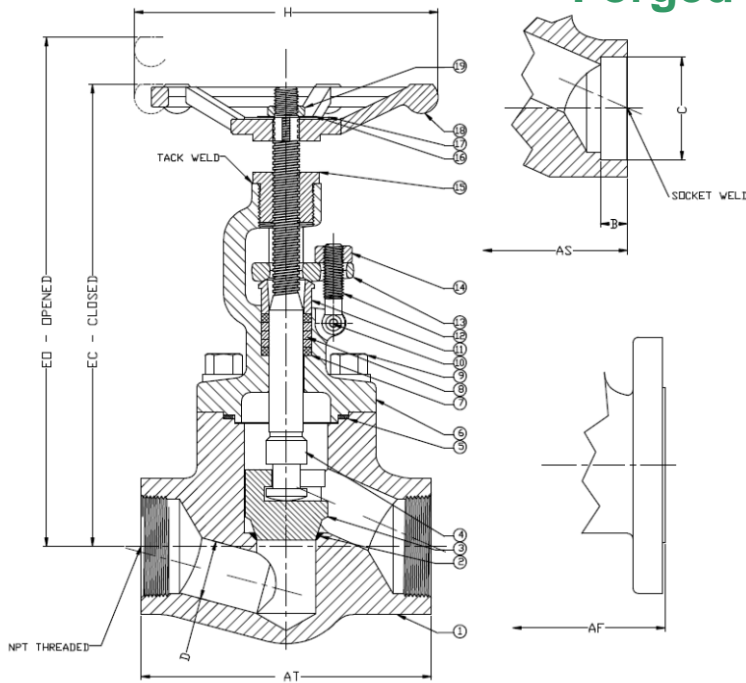

STANDARDS

DESIGN:

API 602
MSS SP-118
ASME B16.34

TESTING:

API 598

PRESSURE CLASS:

NPT & SW – 800
FLANGED – 150,300,600

CONNECTIONS:

NPT – ASME B1.20.1
SW - ASME B16.11
FLANGED – ASME B16.5
ASME B16.10

		MATERIAL LIST							
NO.	Part Name	A105	LF2	F5	F9	F11	F22	F316/F316L	
1	Body	A105N	A350-LF2	A182-F5	A182-F9	A182-F11	A182-F22	A182-F316/F316L	
2	Seat Ring	CoCr-A							A276-316/CoCr-A
3	Disc	A276-420							A276-316
4	Stem	A276-410							A276-316
5	Gasket	Spiral Wound 304/Graphite							316/Graphite
6	Bonnet	A105N	A350-LF2	A182-F5	A182-F9	A182-F11	A182-F22	A182-F316/F316L	
7	Wiper Ring	Braided Graphite							
8	Packing	Die Formed Graphite							
9	Body Bolt	A193-B7	A320-L7	A193-B16				A193-B8M	
10	Eyebolt Pin	A276-410							A276-316
11	Gland	A276-420							A276-316
12	Eyebolt	A193-B7	A320-L7	A193-B16				A193-B8M	
13	Gland Plate	A105							A182-F316
14	Gland Nut	A194-2H	A194-4	A194-7				A194-8M	
15	Op Nut	A276-410							A276-316
16	Washer	A276-410							
17	Nameplate	Aluminum							
18	Handwheel	A197							
19	Handwheel Nut	A194-2H							A194-8

		DIMENSIONS AND WEIGHTS											WGT.			
SIZE		AT	AS	AF-150	AF-300	AF-600	B(Min)	C	D (Min)	EO	EC	H	150	300	600	800
1/2	Inch	3.11	3.11	4.25	5.98	6.50	0.37	0.87	0.37	6.18	5.87	3.94	6.39	7.94	8.60	4.63
	mm	79.0	79.0	108.0	152.0	165.0	9.50	22.0	9.5	161.0	149.0	100.0	2.90	3.60	3.90	2.10
3/4	Inch	3.62	3.62	4.61	7.01	7.48	0.49	1.08	0.49	6.38	5.87	3.94	7.49	10.8	11.7	5.07
	mm	92.0	92.0	117.0	178.0	190.0	12.5	27.4	12.5	161.0	149.0	100.0	3.40	4.90	5.30	2.30
1	Inch	4.37	4.37	5.00	7.99	8.50	0.49	1.34	0.69	7.56	6.97	4.72	11.9	16.3	17.4	8.20
	mm	111.0	111.0	127.0	203.0	216.0	12.5	34.1	17.5	193.0	177.0	120.0	5.40	7.40	7.90	3.70
1-1/4	Inch	4.72	4.72	5.51	8.50	9.02	0.49	1.69	0.93	9.92	8.35	6.30	17.6	25.4	26.5	12.8
	mm	120.0	120.0	140.0	216.0	229.0	12.5	42.9	23.5	230.0	212.0	160.0	8.00	11.5	12.0	5.80
1-1/2	Inch	5.98	5.98	6.50	9.02	9.49	0.49	1.93	1.12	9.92	8.81	6.30	21.6	30.0	32.8	16.5
	mm	152.0	152.0	165.0	229.0	241.0	12.5	49.0	28.5	248.0	224.0	160.0	9.80	13.6	14.9	7.50
2	Inch	6.77	6.77	7.99	10.5	11.5	0.63	2.42	1.42	11.4	10.1	8.66	35.7	43.4	48.7	22.5
	mm	172.0	172.0	203.0	267.0	292.0	16.0	61.5	36.5	290.0	256.0	220.0	16.2	19.7	22.1	10.2

(713) 673-2073 – Fax (713) 673-4641 - Toll Free (866) GO-BERIC (462-3742)

www.bericvalves.com

Piston Check Valve Standard Port, Bolted Bonnet Forged Steel

503 SERIES

STANDARDS

DESIGN:

API 602
MSS SP-118
ASME B16.34

TESTING:

API 598

PRESSURE CLASS:

NPT & SW – 800
FLANGED – 150,300,600

CONNECTIONS:

NPT – ASME B1.20.1
SW - ASME B16.11
FLANGED – ASME B16.5
ASME B16.10

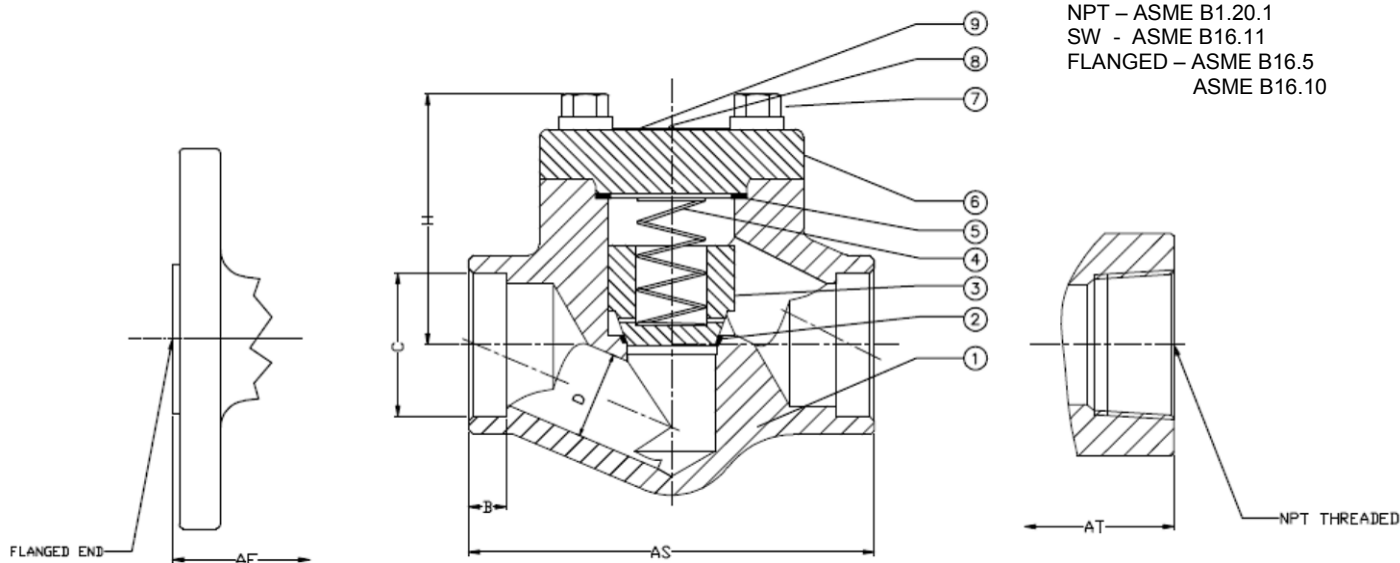

MATERIAL LIST								
NO.	Part Name	A105	LF2	F5	F9	F11	F22	F316/F316L
1	Body	A105N	A350-LF2	A182-F5	A182-F9	A182-F11	A182-F22	A182-F316/F316L
2	Seat Ring	CoCr-A						316/CoCr-A
3	Disc	A276-420						
4	Spring	A276-316						
5	Gasket	Spiral Wound 304/Graphite						316/Graphite
6	Bonnet	A105N	A350-LF2	A182-F5	A182-F9	A182-F11	A182-F22	A182-F316/F316L
7	Body Bolt	A193-B7	A320-L7	A193-B16		A193-B8M		
8	Rivet	A276-410						
9	Nameplate	Aluminum						

DIMENSIONS AND WEIGHTS

SIZE		AT	AS	AF-150	AF-300	AF-600	B (Min)	C	D (Min)	H	WGT.			
											150	300	600	800
1/2	Inch	3.11	3.11	4.25	5.98	6.50	0.37	0.87	0.37	2.28	4.85	6.17	7.05	3.09
	mm	79.0	79.0	108.0	152.0	165.0	9.50	22.0	9.50	58.0	2.20	2.80	3.20	1.40
3/4	Inch	3.62	3.62	4.61	7.01	7.48	0.49	1.08	0.49	2.28	5.95	9.26	9.92	3.31
	mm	92.0	92.0	117.0	178.0	190.0	12.5	27.4	12.5	58.0	2.70	4.20	4.50	1.50
1	Inch	4.37	4.37	5.00	8.00	8.50	0.49	1.34	0.69	2.95	9.70	13.9	15.2	5.95
	mm	111.0	111.0	127.0	203.0	216.0	12.5	34.1	17.5	75.0	4.40	6.30	6.90	2.70
1-1/4	Inch	4.72	4.72	5.51	8.50	9.02	0.49	1.69	0.93	3.35	14.3	17.9	22.9	8.6
	mm	120.0	120.0	140.0	216.0	229.0	12.5	42.9	23.5	85.0	6.50	8.10	10.4	3.90
1-1/2	Inch	5.98	5.98	6.50	9.02	9.49	0.49	1.93	1.12	3.82	17.6	25.8	28.7	11.7
	mm	152.0	152.0	165.0	229.0	241.0	12.5	49.0	28.5	97.0	8.00	11.7	13.0	5.30
2	Inch	6.77	6.77	7.99	10.5	11.5	0.63	2.42	1.44	4.53	30.4	38.6	43.7	17.2
	mm	172.0	172.0	203.0	267.0	292.0	16.0	61.5	36.5	115.0	13.8	17.5	19.8	7.80

(713) 673-2073 – Fax (713) 673-4641 - Toll Free (866) GO-BERIC (462-3742)

www.bericvalves.com

Swing Check Valve Standard Port, Bolted Bonnet Forged Steel

504 SERIES

STANDARDS

DESIGN:

API 602
MSS SP-118
ASME B16.34

TESTING:

API 598

PRESSURE CLASS:

NPT & SW – 800
FLANGED – 150,300,600

CONNECTIONS:

NPT – ASME B1.20.1
SW - ASME B16.11
FLANGED – ASME B16.5
ASME B16.10

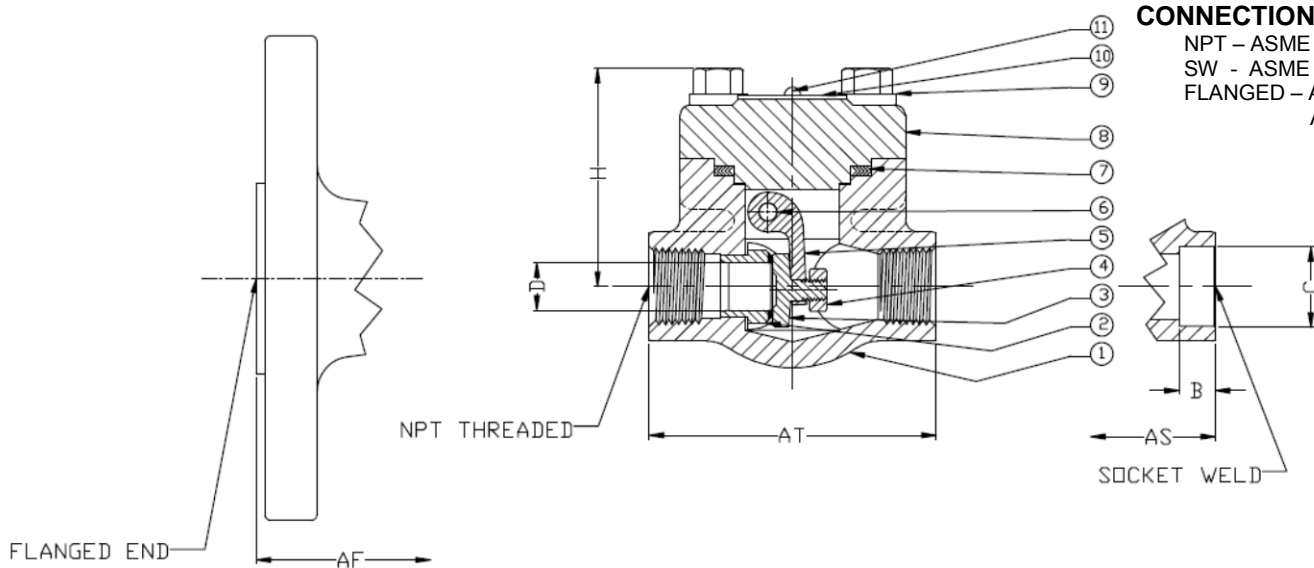

MATERIAL LIST								
NO.	Part Name	A105	LF2	F5	F9	F11	F22	F316/F316L
1	Body	A105N	A350-LF2	A182-F5	A182-F9	A182-F11	A182-F22	A182-F316/F316L
2	Seat Ring	A276-410/CoCr-A						316/CoCr-A
3	Disc	A276-410						A276-316
4	Disc Nut	A194-8						A194-8M
5	Swing Arm	A351-CF8						A351-CF8M
6	Hinge Pin	A276-316						
7	Gasket	Spiral Wound 316/Graphite						
8	Bonnet	A105N	A350-LF2	A182-F5	A182-F9	A182-F11	A182-F22	A182-F316/F316L
9	Body Bolt	A193-B7	A320-L7	A193-B16				A193-B8M
10	Nameplate	Aluminum						
11	Rivet	A276-410						

DIMENSIONS AND WEIGHTS

SIZE		AT	AS	AF-150	AF-300	AF-600	B(Min)	C	D (Min)	H	WGT.			
											150	300	600	800
1/2	Inch	3.11	3.11	4.25	5.98	6.50	0.37	0.87	0.37	2.28	4.41	6.17	7.05	2.87
	mm	79.0	79.0	108.0	152.0	165.0	9.50	22.0	9.50	58.0	2.00	2.80	3.20	1.30
3/4	Inch	3.62	3.62	4.61	7.01	7.48	0.49	1.08	0.51	2.28	5.73	8.81	9.48	3.31
	mm	92.0	92.0	117.0	178.0	190.0	12.5	27.4	13.0	58.0	2.60	4.00	4.30	1.50
1	Inch	4.37	4.37	5.00	8.50	8.50	0.49	1.34	0.71	2.95	9.26	13.4	14.3	5.95
	mm	111.0	111.0	127.0	216.0	216.0	12.5	34.1	18.0	75.0	4.20	6.10	6.50	2.70
1-1/4	Inch	4.72	4.72	5.51	9.02	9.02	0.49	1.69	0.94	3.35	13.4	17.6	18.7	8.16
	mm	120.0	120.0	140.0	229.0	229.0	12.5	42.9	24.0	85.0	6.10	8.00	8.50	3.70
1-1/2	Inch	4.72	4.72	6.50	9.49	9.49	0.49	1.93	1.14	3.82	16.3	24.3	27.1	9.70
	mm	120.0	120.0	165.0	241.0	241.0	12.5	49.0	29.0	97.0	7.40	11.0	12.3	4.40
2	Inch	5.51	5.51	7.99	10.5	11.5	0.63	2.42	1.44	4.53	28.7	35.5	38.8	14.3
	mm	140.0	140.0	203.0	267.0	292.0	16.0	61.5	36.5	115.0	13.0	16.1	17.6	6.50

Gate Valve Standard Port, Welded Bonnet Forged Steel

505 SERIES

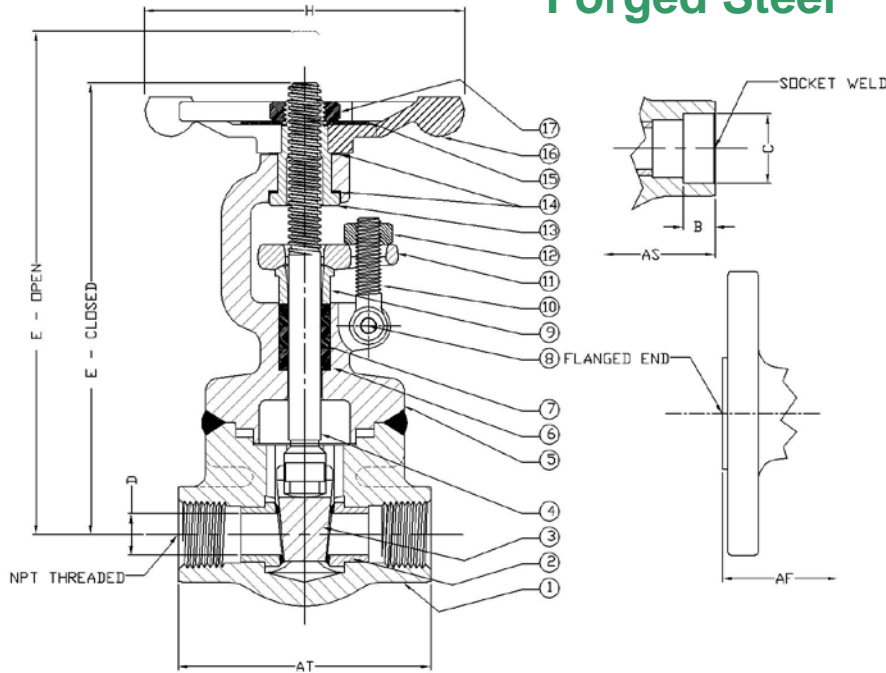

STANDARDS

DESIGN:

API 602
ASME B16.34

TESTING:

API 598

PRESSURE CLASS:

NPT & SW – 800
FLANGED – 150,300,600

CONNECTIONS:

NPT – ASME B1.20.1
SW - ASME B16.11
FLANGED – ASME B16.5
ASME B16.10

MATERIAL LIST								
NO.	Part Name	A105	LF2	F5	F9	F11	F22	F316/F316L
1	Body	A105N	A350-LF2	A182-F5	A182-F9	A182-F11	A182-F22	A182-F316/F316L
2	Seat Ring	A276-410/CoCr-A						A276-316/CoCr-A
3	Gate	A276-420						A276-316
4	Stem	A276-410						A276-316
5	Bonnet	A105N	A350-LF2	A182-F5	A182-F9	A182-F11	A182-F22	A182-F316/F316L
6	Wiper Ring	Braided Graphite						
7	Packing	Die Formed Graphite						
8	Eyebolt Pin	A276-410						A276-316
9	Gland	A276-420						A276-316
10	Eyebolt	A193-B7	A320-L7	A193 B16			A193-B8M	
11	Gland Plate	A105						A182-F316
12	Gland Nut	A194-2H	A194-4	A194-7			A194-8M	
13	Op Nut	A276-410						A276-410
14	Washer	A276-410						
15	Nameplate	Aluminum						
16	Handwheel	A197						
17	Handwheel Nut	A194-2H						A194-8

SIZE	DIMENSIONS AND WEIGHTS											WGT.				
	AT	AS	AF-150	AF-300	AF-600	B (Min)	C	D (Min)	EO	EC	H	150	300	600	800	
1/2	Inch	3.11	3.11	4.25	5.51	6.50	0.37	0.87	0.37	6.22	5.63	3.94	7.50	8.31	9.26	3.75
	mm	79.0	79.0	108.0	140.0	165.0	9.50	22.0	9.50	158.0	143.0	100.0	3.40	3.77	4.20	1.70
3/4	Inch	3.62	3.62	4.61	5.98	7.48	0.49	1.08	0.51	6.38	5.79	3.94	8.77	10.8	12.8	4.41
	mm	92.0	92.0	117.0	152.0	190.0	12.5	27.4	13.0	162.0	147.0	100.0	3.98	4.89	5.80	2.00
1	Inch	4.37	4.37	5.00	6.50	8.50	0.49	1.34	0.71	7.80	7.01	4.92	13.5	15.9	19.4	8.38
	mm	111.0	111.0	127.0	165.0	216.0	12.5	34.1	18.0	198.0	178.0	125.0	6.12	7.23	8.80	3.80
1-1/4	Inch	4.72	4.72	5.51	7.01	9.02	0.49	1.69	0.94	9.06	7.95	6.30	19.9	23.4	29.5	12.8
	mm	120.0	120.0	140.0	178.0	229.0	12.5	42.9	24.0	230.0	202.0	160.0	9.04	10.6	13.4	5.80
1-1/2	Inch	4.72	4.72	6.50	7.48	9.49	0.49	1.93	1.14	9.69	8.31	6.30	22.9	27.8	34.4	14.1
	mm	120.0	120.0	165.0	190.0	241.0	12.5	49.0	29.0	246.0	211.0	160.0	10.4	12.6	15.6	6.40
2	Inch	5.51	5.51	7.01	8.50	11.5	0.63	2.42	1.44	11.14	9.45	8.66	34.2	39.7	43.0	22.0
	mm	140.0	140.0	178.0	216.0	292.0	16.0	61.5	36.5	283.0	240.0	220.0	15.5	18.0	19.5	10.0

Globe Valve

Standard Port, Welded Bonnet Forged Steel

506 SERIES

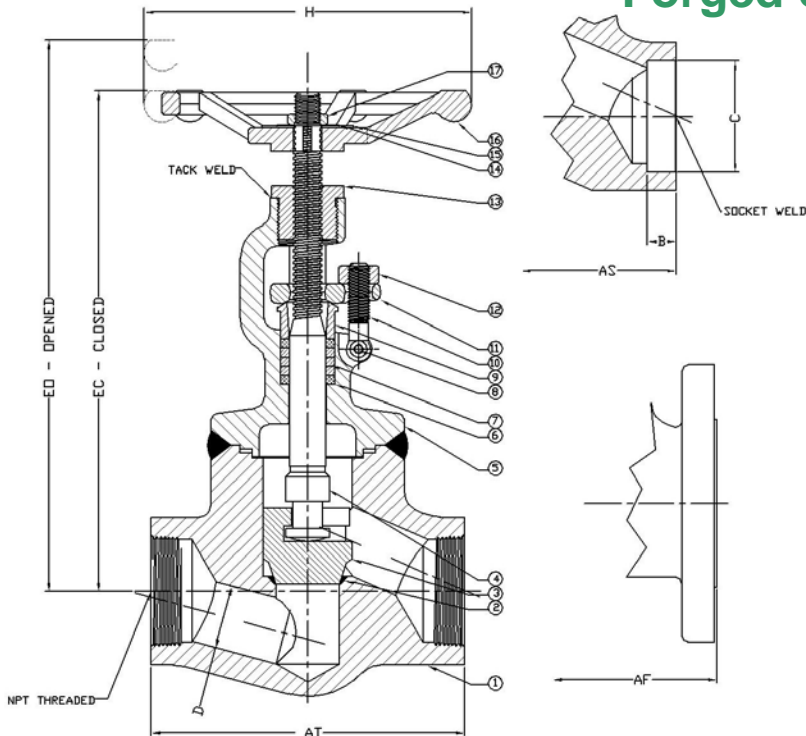

STANDARDS

DESIGN:

API 602
MSS SP-118
ASME B16.34

TESTING:

API 598

PRESSURE CLASS:

NPT & SW – 800
FLANGED – 150,300,600

CONNECTIONS:

NPT – ASME B1.20.1
SW - ASME B16.11
FLANGED – ASME B16.5
ASME B16.10

MATERIAL LIST

NO.	Part Name	A105	LF2	F5	F9	F11	F22	F316/F316L	
1	Body	A105N	A350-LF2	A182-F5	A182-F9	A182-F11	A182-F22	A182-F316/F316L	
2	Seat Ring	CoCr-A							A276-316/CoCr-A
3	Disc	A276-420							A276-316
4	Stem	A276-410							A276-316
5	Bonnet	A105N	A350-LF2	A182-F5	A182-F9	A182-F11	A182-F22	A182-F316/F316L	
6	Wiper Ring	Braided Graphite							
7	Packing	Die Formed Graphite							
8	Eyebolt Pin	A276-410							A276-316
9	Gland	A276-420							A276-316
10	Eyebolt	A193-B7	A320-L7	A193-B16				A193-B8M	
11	Gland Plate	A105							A182-F316
12	Gland Nut	A194-2H	A194-4	A194-7				A194-8M	
13	Op Nut	A276-410							A276-410
14	Washer	A276-410							
15	Nameplate	Aluminum							
16	Handwheel	A197							
17	Handwheel Nut	A194-2H							A194-8

DIMENSIONS AND WEIGHTS

SIZE		DIMENSIONS AND WEIGHTS											WGT.			
		AT	AS	AF-150	AF-300	AF-600	B (Min)	C	D (Min)	EO	EC	H	150	300	600	800
1/2	Inch	3.11	3.11	4.25	5.98	6.50	0.37	0.87	0.39	6.54	6.10	3.94	7.61	8.38	12.35	3.97
	mm	79.0	79.0	108.0	152.0	165.0	9.50	22.0	9.50	166.0	155.0	100.0	3.45	3.80	5.60	1.80
3/4	Inch	3.62	3.62	4.61	7.01	7.48	0.49	1.08	0.51	6.65	6.10	3.94	8.82	11.2	17.2	4.41
	mm	92.0	92.0	117.0	178.0	190.0	12.5	27.4	12.5	169.0	155.0	100.0	4.00	5.10	7.80	2.00
1	Inch	4.37	4.37	5.00	7.99	8.50	0.49	1.34	0.71	8.07	7.60	4.72	13.7	15.9	27.6	8.38
	mm	111.0	111.0	127.0	203.0	216.0	12.5	34.1	17.5	205.0	193.0	120.0	6.19	7.20	12.5	3.80
1-1/4	Inch	4.72	4.72	5.51	8.50	9.02	0.49	1.69	0.91	9.41	8.60	6.30	21.2	25.3	37.5	12.8
	mm	120.0	120.0	140.0	216.0	229.0	12.5	42.9	23.5	239.0	218.0	160.0	9.60	11.5	17.0	5.80
1-1/2	Inch	5.98	5.98	6.50	9.02	9.49	0.49	1.93	1.18	9.92	9.13	6.30	23.2	29.8	51.8	16.5
	mm	152.0	152.0	165.0	229.0	241.0	12.5	49.0	28.0	252.0	232.0	160.0	10.5	13.5	23.5	7.50
2	Inch	6.77	6.77	7.99	10.5	11.5	0.63	2.42	1.42	11.4	10.6	8.66	37.5	43.4	85.5	26.2
	mm	172.0	172.0	203.0	267.0	292.0	16.0	61.5	36.5	289.0	268.0	220.0	17.0	19.7	38.8	11.9

(713) 673-2073 – Fax (713) 673-4641 - Toll Free (866) GO-BERIC (462-3742)

www.bericvalves.com

Piston Check Valve Standard Port, Welded Bonnet Forged Steel

507 SERIES

STANDARDS

DESIGN:

API 602
MSS SP-118
ASME B16.34

TESTING:

API 598

PRESSURE CLASS:

NPT & SW – 800
FLANGED – 150,300,600

CONNECTIONS:

NPT – ASME B1.20.1
SW - ASME B16.11
FLANGED – ASME B16.5
ASME B16.10

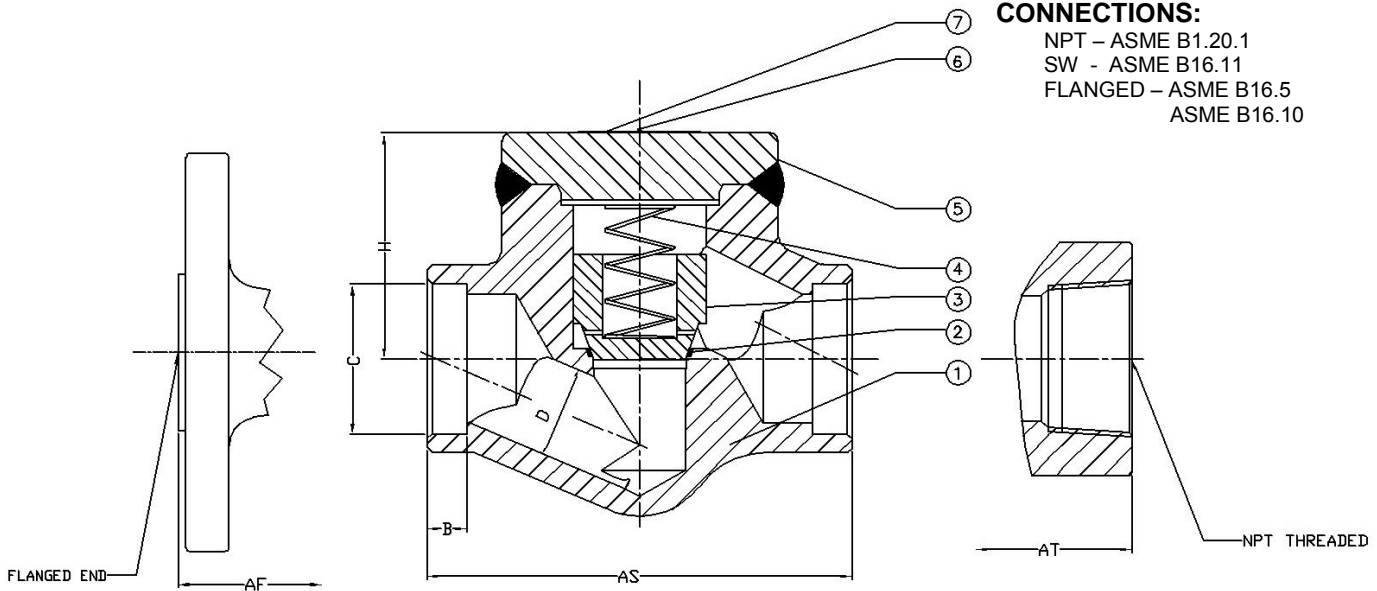

MATERIAL LIST								
NO.	Part Name	A105	LF2	F5	F9	F11	F22	F316/F316L
1	Body	A105N	A350-LF2	A182-F5	A182-F9	A182-F11	A182-F22	A182-F316/F316L
2	Seat Ring	CoCr-A						A182-F316/F316L
3	Disc	A276-420						316/CoCr-A
4	Spring	A276-316						
5	Bonnet	A105N	A350-LF2	A182-F5	A182-F9	A182-F11	A182-F22	A182-F316/F316L
6	Rivet	A276-410						
7	Nameplate	Aluminum						

DIMENSIONS AND WEIGHTS

SIZE		AT	AS	AF-150	AF-300	AF-600	B(Min)	C	D (Min)	H	WGT.			
											150	300	600	800
1/2	Inch	3.11	3.11	4.25	5.98	6.50	0.37	0.87	0.35	2.40	7.94	8.16	8.82	2.65
	mm	79.0	79.0	108.0	152.0	165.0	9.50	22.0	9.00	50.0	3.60	3.70	4.00	1.20
3/4	Inch	3.62	3.62	4.61	7.01	7.48	0.49	1.08	0.49	2.40	10.1	10.6	12.8	3.30
	mm	92.0	92.0	117.0	178.0	190.0	12.5	27.4	12.5	52.0	4.60	4.80	5.80	1.50
1	Inch	4.37	4.37	5.00	7.99	8.50	0.49	1.34	0.69	3.07	18.8	19.4	20.9	5.73
	mm	111.0	111.0	127.0	203.0	216.0	12.5	34.1	17.5	70.0	8.50	8.80	9.50	2.60
1-1/4	Inch	4.72	4.72	5.51	8.50	9.02	0.49	1.69	0.93	3.31	20.3	21.2	22.9	9.26
	mm	120.0	120.0	140.0	216.0	229.0	12.5	42.9	23.5	82.0	9.20	9.60	10.4	4.20
1-1/2	Inch	5.98	5.98	6.50	9.02	9.49	0.49	1.93	1.12	3.31	27.6	30.2	34.4	12.3
	mm	152.0	152.0	165.0	229.0	241.0	12.5	49.0	28.5	96.0	12.5	13.7	15.6	5.60
2	Inch	6.77	6.77	7.99	10.5	11.5	0.63	2.42	1.42	4.72	32.6	39.2	54.0	20.5
	mm	172.0	172.0	203.0	267.0	292.0	16.0	61.5	36.0	110.0	14.8	17.8	24.5	9.30

Swing Check Valve Standard Port, Welded Bonnet Forged Steel

508 SERIES

STANDARDS

DESIGN:

API 602
MSS SP-118
ASME B16.34

TESTING:

API 598

PRESSURE CLASS:

NPT & SW – 800
FLANGED – 150,300,600

CONNECTIONS:

NPT – ASME B1.20.1
SW - ASME B16.11
FLANGED – ASME B16.5
ASME B16.10

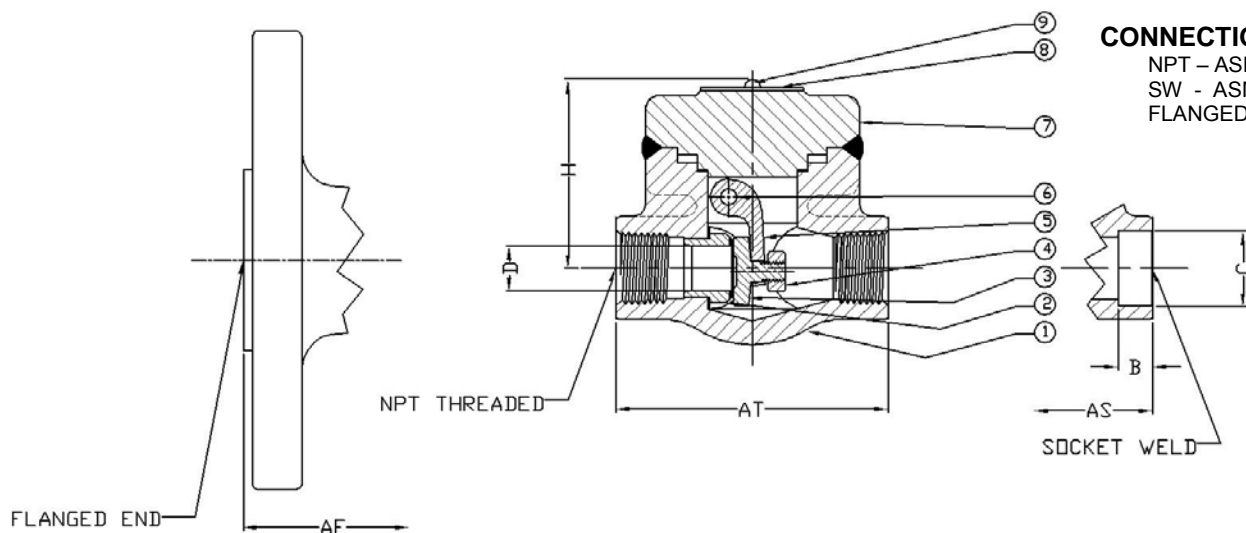

MATERIAL LIST								
NO.	Part Name	A105	LF2	F5	F9	F11	F22	F316/F316L
1	Body	A105N	A350-LF2	A182-F5	A182-F9	A182-F11	A182-F22	A182-F316/F316L
2	Seat Ring	A276-410/CoCr-A						316/CoCr-A
3	Disc	A276-410						A276-316
4	Disc Nut	A194-8						A194-8M
5	Swing Arm	A276-316						A351-CF8M
6	Hinge Pin	A276-316						
7	Bonnet	A105N	A350-LF2	A182-F5	A182-F9	A182-F11	A182-F22	A182-F316/F316L
8	Nameplate	Aluminum						
9	Rivet	A276-410						

DIMENSIONS AND WEIGHTS

SIZE		AT	AS	AF-150	AF-300	AF-600	B(Min)	C	D (Min)	H	WGT.			
											150	300	600	800
1/2	Inch	3.11	3.11	4.25	5.98	6.50	0.37	0.87	0.39	2.40	7.94	8.16	8.82	3.31
	mm	79.0	79.0	108.0	152.0	165.0	9.50	22.0	10.0	61.0	3.60	3.70	4.00	1.50
3/4	Inch	3.62	3.62	4.61	7.01	7.48	0.49	1.08	0.51	2.40	10.1	10.6	12.8	3.75
	mm	92.0	92.0	117.0	178.0	190.0	12.5	27.4	13.0	61.0	4.60	4.80	5.80	1.70
1	Inch	4.37	4.37	5.00	8.50	8.50	0.49	1.34	0.71	3.07	18.8	19.4	20.9	7.28
	mm	111.0	111.0	127.0	216.0	216.0	12.5	34.1	18.0	78.0	8.50	8.80	9.50	3.30
1-1/4	Inch	4.72	4.72	5.51	9.02	9.02	0.49	1.69	0.94	3.31	20.3	21.2	22.9	9.26
	mm	120.0	120.0	140.0	229.0	229.0	12.5	42.9	24.0	84.0	9.20	9.60	10.4	4.20
1-1/2	Inch	4.72	4.72	6.50	9.49	9.49	0.49	1.93	1.14	3.31	27.6	30.2	34.4	9.26
	mm	120.0	120.0	165.0	241.0	241.0	12.5	49.0	29.0	84.0	12.5	13.7	15.6	4.20
2	Inch	5.51	5.51	7.99	10.5	11.5	0.63	2.42	1.42	4.72	32.6	39.2	54.0	18.7
	mm	140.0	140.0	203.0	267.0	292.0	16.0	61.5	36.0	120.0	14.8	17.8	24.5	8.50

Gate Valve Full Port, Bolted Bonnet Forged Steel

511 SERIES

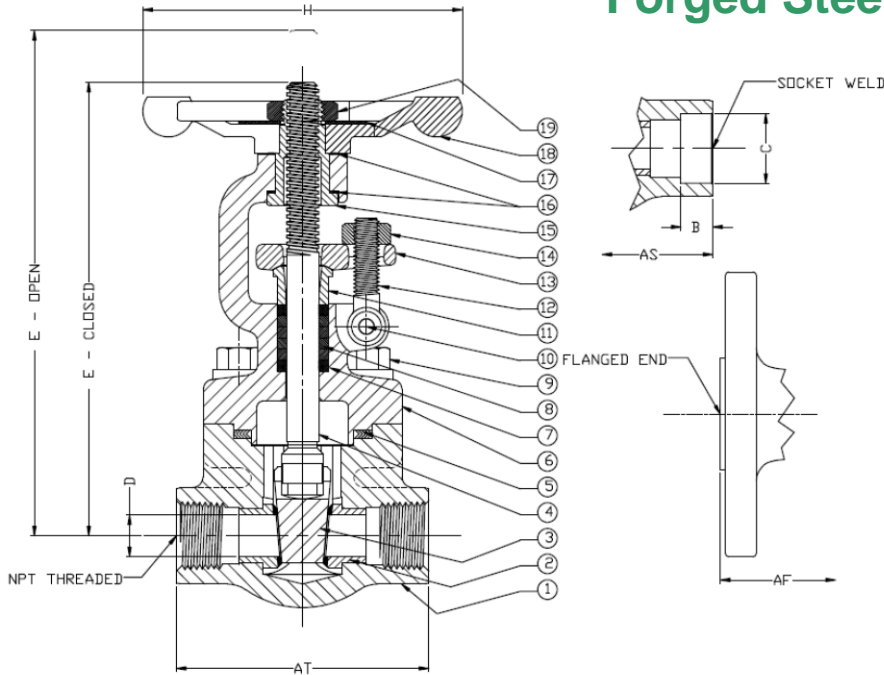

STANDARDS

DESIGN:

API 602
ASME B16.34

TESTING:

API 598

PRESSURE CLASS:

NPT & SW – 800
FLANGED – 150,300,600

CONNECTIONS:

NPT – ASME B1.20.1
SW - ASME B16.11
FLANGED – ASME B16.5
ASME B16.10

MATERIAL LIST								
NO.	Part Name	A105	LF2	F5	F9	F11	F22	F316/F316L
1	Body	A105N	A350-LF2	A182-F5	A182-F9	A182-F11	A182-F22	A182-F316/F316L
2	Seat Ring	A276-410/CoCr-A						A276-316/CoCr-A
3	Gate	A276-410						A276-316
4	Stem	A276-420						A276-316
5	Gasket	Spiral Wound 304/Graphite						316/Graphite
6	Bonnet	A105N	A350-LF2	A182-F5	A182-F9	A182-F11	A182-F22	A182-F316/F316L
7	Wiper Ring	Braided Graphite						
8	Packing	Die Formed Graphite						
9	Body Bolt	A193-B7	A320-L7	A193-B16				A193-B8M
10	Eyebolt Pin	A276-410						A276-316
11	Gland	A276-410						A276-316
12	Eyebolt	A193-B7	A320-L7	A193-B16				A193-B8M
13	Gland Plate	A105						A182-F316
14	Gland Nut	A194-2H	A194-4	A194-7				A194-8M
15	Op Nut	A276-410						A276-410
16	Washer	A276-410						
17	Nameplate	Aluminum						
18	Handwheel	A197						
19	Handwheel Nut	A194-2H						A194-8

DIMENSIONS AND WEIGHTS												WGT.				
SIZE		AT	AS	AF-150	AF-300	AF-600	B (Min)	C	D (Min)	EO	EC	H	150	300	600	800
1/2	Inch	3.11	3.11	4.25	5.51	6.50	0.37	0.87	0.51	6.22	5.51	3.94	8.77	10.8	12.8	4.41
	mm	79.0	79.0	108.0	140.0	165.0	9.50	22.0	13.0	158.0	140.0	100.0	3.98	4.89	5.80	2.00
3/4	Inch	4.37	4.37	4.61	5.98	7.48	0.49	1.08	0.71	7.30	6.50	4.72	13.5	15.9	19.4	8.16
	mm	111.0	111.0	117.0	152.0	190.0	12.5	27.4	18.0	185.0	165.0	120.0	6.12	7.23	8.80	3.70
1	Inch	4.72	4.72	5.00	6.50	8.50	0.49	1.34	.94	8.90	7.87	6.30	19.9	23.3	29.5	12.6
	mm	120.0	120.0	127.0	165.0	216.0	12.5	34.1	24.0	226.0	200.0	160.0	9.04	10.6	13.4	5.70
1-1/4	Inch	4.72	4.72	5.51	7.01	9.02	0.49	1.69	1.14	9.5	8.31	6.30	22.9	27.9	34.4	14.3
	mm	120.0	120.0	140.0	178.0	229.0	12.5	42.9	29.0	241.0	211.0	160.0	10.4	12.6	15.6	6.5
1-1/2	Inch	5.51	5.51	6.50	7.48	9.49	0.49	1.93	1.44	10.6	9.02	8.66	34.2	39.7	43.0	21.2
	mm	140.0	140.0	165.0	190.0	241.0	12.5	49.0	36.5	269.0	229.0	220.0	15.5	18.0	19.5	9.6
2	Inch	6.30	6.30	7.01	8.50	11.5	0.63	2.42	1.73	12.8	10.9	8.66	47.4	52.9	56.2	34.2
	mm	160.0	160.0	178.0	216.0	292.0	16.0	61.5	44.0	324.0	276.0	220.0	21.5	24.0	25.5	15.5

(713) 673-2073 – Fax (713) 673-4641 - Toll Free (866) GO-BERIC (462-3742)

www.bericvalves.com

Globe Valve Full Port, Bolted Bonnet Forged Steel

522 SERIES

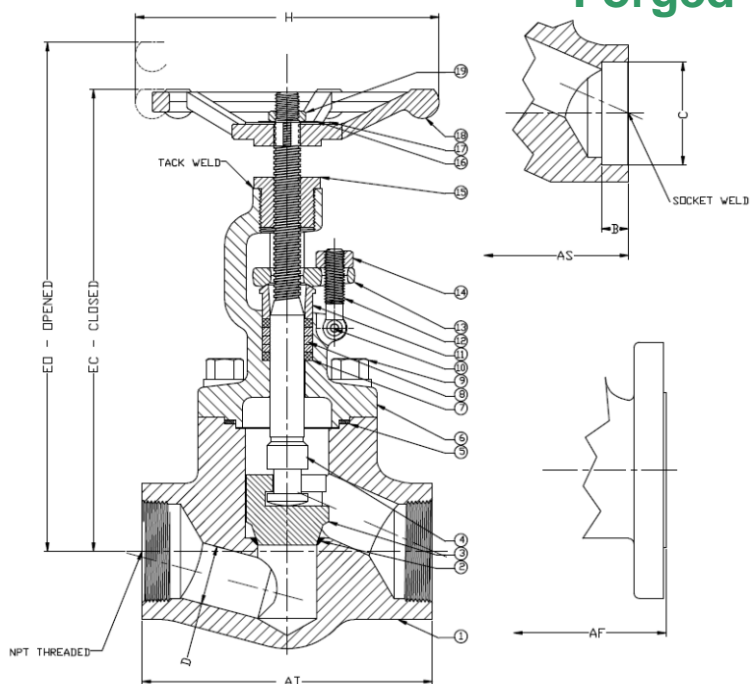

STANDARDS

DESIGN:

API 602
MSS SP-118
ASME B16.34

TESTING:

API 598

PRESSURE CLASS:

NPT & SW – 800
FLANGED – 150,300,600

CONNECTIONS:

NPT – ASME B1.20.1
SW - ASME B16.11
FLANGED – ASME B16.5
ASME B16.10

		MATERIAL LIST								
NO.	Part Name	A105	LF2	F5	F9	F11	F22	F316/F316L		
1	Body	A105N	A350-LF2	A182-F5	A182-F9	A182-F11	A182-F22	A182-F316/F316L		
2	Seat Ring	CoCr-A							A276-316/CoCr-A	
3	Disc	A276-420							A276-316	
4	Stem	A276-410							A276-316	
5	Gasket	Spiral Wound 304/Graphite							316/Graphite	
6	Bonnet	A105N	A350-LF2	A182-F5	A182-F9	A182-F11	A182-F22	A182-F316/F316L		
7	Wiper Ring	Braided Graphite								
8	Packing	Die Formed Graphite								
9	Body Bolt	A193-B7	A320-L7	A193-B16				A193-B8M		
10	Eyebolt Pin	A276-410							A276-316	
11	Gland	A276-410							A276-316	
12	Eyebolt	A193-B7	A320-L7	A193-B16				A193-B8M		
13	Gland Plate	A105							A182-F316	
14	Gland Nut	A194-2H	A194-4	A194-7						
15	Op Nut	A276-410							A276-316	
16	Washer	A276-410								
17	Nameplate	Aluminum								
18	Handwheel	A197								
19	Handwheel Nut	A194-2H							A194-8	

SIZE		DIMENSIONS AND WEIGHT										WGT.				
		AT	AS	AF-150	AF-300	AF-600	B(Min)	C	D (Min)	EO	EC	H	150	300	600	800
1/2	Inch	3.11	3.11	4.25	5.98	6.50	0.37	0.87	0.49	6.34	5.87	3.94	8.82	11.2	17.2	4.63
	mm	79.0	79.0	108.0	152.0	165.0	9.50	22.0	12.5	161.0	149.0	100.0	4.00	5.10	7.80	2.10
3/4	Inch	4.37	4.37	4.61	7.01	7.48	0.49	1.08	0.69	7.60	6.97	4.72	13.7	15.9	27.6	8.38
	mm	111.0	111.0	117.0	178.0	190.0	12.5	27.4	17.5	193.0	177.0	120.0	6.19	7.20	12.5	3.80
1	Inch	4.72	4.72	5.00	7.99	8.50	0.49	1.34	0.89	9.06	8.35	6.30	21.2	25.3	37.5	13.0
	mm	120.0	120.0	127.0	203.0	216.0	12.5	34.1	22.5	230.0	212.0	160.0	9.60	11.5	17.0	5.90
1-1/4	Inch	5.98	5.98	5.51	8.50	9.02	0.49	1.69	1.12	11.2	8.82	6.30	23.2	29.8	51.8	16.8
	mm	152.0	152.0	140.0	216.0	229.0	12.5	42.9	28.5	248.0	224.0	160.0	10.5	13.5	23.5	7.60
1-1/2	Inch	6.77	6.77	6.50	9.01	9.49	0.49	1.93	1.40	11.1	9.92	8.66	37.5	43.4	85.5	22.7
	mm	172.0	172.0	165.0	229.0	241.0	12.5	49.0	35.5	282.0	252.0	220.0	17.0	19.7	38.8	10.3
2	Inch	8.66	8.66	7.99	10.5	11.5	0.63	2.42	1.75	13.6	12.4	8.66	48.5	54.5	96.6	49.4
	mm	220.0	220.0	203.0	267.0	292.0	16.0	61.5	44.5	346.0	316.0	220.0	22.0	24.7	43.8	22.4

(713) 673-2073 – Fax (713) 673-4641 - Toll Free (866) GO-BERIC (462-3742)

www.bericvalves.com

Piston Check Valve

Full Port, Bolted Bonnet Forged Steel

523 SERIES

STANDARDS

DESIGN:

API 602
MSS SP-118
ASME B16.34

TESTING:

API 598

PRESSURE CLASS:

NPT & SW – 800
FLANGED – 150,300,600

CONNECTIONS:

NPT – ASME B1.20.1
SW - ASME B16.11
FLANGED – ASME B16.5
ASME B16.10

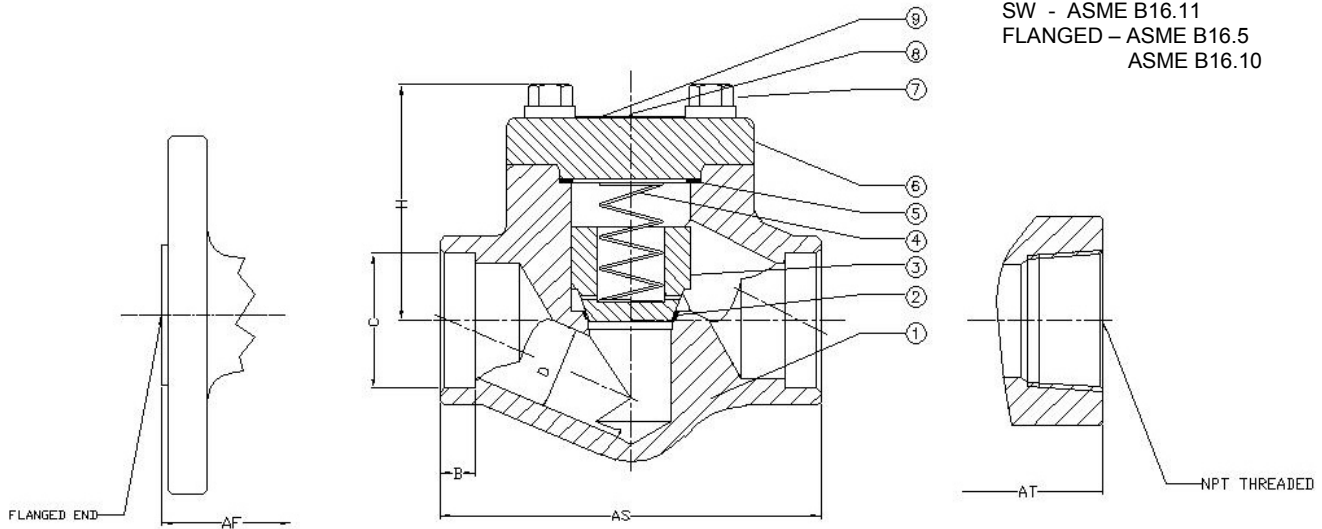

MATERIAL LIST								
NO.	Part Name	A105	LF2	F5	F9	F11	F22	F316/F316L
1	Body	A105N	A350-LF2	A182-F5	A182-F9	A182-F11	A182-F22	A182-F316/F316L
2	Seat Ring	CoCr-A						316/CoCr-A
3	Disc	A276-420						
4	Spring	A276-316						
5	Gasket	Spiral Wound 304/Graphite						316/Graphite
6	Bonnet	A105N	A350-LF2	A182-F5	A182-F9	A182-F11	A182-F22	A182-F316/F316L
7	Body Bolt	A193-B7	A320-L7	A193-B16		A193-B8M		
8	Rivet	A276-410						
9	Nameplate	Aluminum						

DIMENSIONS AND WEIGHTS

SIZE		AT	AS	AF-150	AF-300	AF-600	B(Min)	C	D (Min)	H	WGT.			
											150	300	600	800
1/2	Inch	3.11	3.11	4.25	5.98	6.50	0.37	0.87	0.49	2.40	10.1	10.6	12.8	3.75
	mm	79.0	79.0	108.0	152.0	165.0	9.50	22.0	12.5	61.0	4.60	4.80	5.80	1.70
3/4	Inch	4.37	4.37	4.61	7.01	7.48	0.49	1.08	0.69	3.07	18.8	19.4	20.9	7.28
	mm	111.0	111.0	117.0	178.0	190.0	12.5	27.4	17.5	78.0	8.50	8.80	9.50	3.30
1	Inch	4.72	4.72	5.00	7.99	8.50	0.49	1.34	0.89	3.31	20.3	21.2	22.9	9.26
	mm	120.0	120.0	127.0	203.0	216.0	12.5	34.1	22.5	84.0	9.20	9.60	10.4	4.20
1-1/4	Inch	5.98	5.98	5.51	8.50	9.02	0.49	1.69	1.12	3.31	27.6	30.2	34.4	9.26
	mm	152.0	152.0	140.0	216.0	229.0	12.5	42.9	28.5	84.0	12.5	13.7	15.6	4.20
1-1/2	Inch	6.77	6.77	6.50	9.02	9.49	0.49	1.93	1.40	4.72	32.6	39.2	54.0	23.2
	mm	172.0	172.0	165.0	229.0	241.0	12.5	49.0	35.5	120.0	14.8	17.8	24.5	10.5
2	Inch	8.66	8.66	7.99	10.5	11.5	0.63	2.42	1.75	5.19	37.0	43.7	58.4	27.6
	mm	220.0	220.0	203.0	267.0	292.0	16.0	61.5	44.5	132.0	16.8	19.8	26.5	12.5

Swing Check Valve Full Port, Bolted Bonnet Forged Steel

514 SERIES

STANDARDS

DESIGN:

API 602
MSS SP-118
ASME B16.34

TESTING:

API 598

PRESSURE CLASS:

NPT & SW – 800
FLANGED – 150,300,600

CONNECTIONS:

NPT – ASME B1.20.1
SW - ASME B16.11
FLANGED – ASME B16.5
ASME B16.10

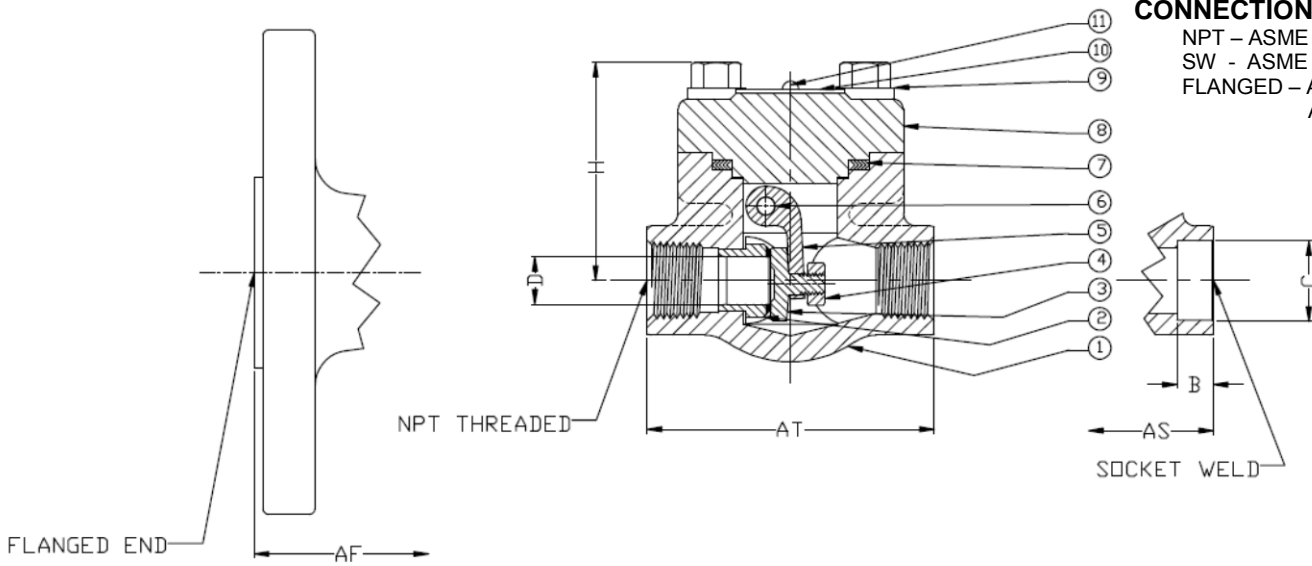

MATERIAL LIST								
NO.	Part Name	A105	LF2	F5	F9	F11	F22	F316/F316L
1	Body	A105N	A350-LF2	A182-F5	A182-F9	A182-F11	A182-F22	A182-F316/F316L
2	Seat Ring	A276-410/CoCr-A						316/CoCr-A
3	Disc	A276-410						A276-316
4	Disc Nut	A194-8						A194-8M
5	Swing Arm	A276-316						A351-CF8M
6	Hinge Pin	A276-316						
7	Gasket	Spiral Wound 304/Graphite						316/Graphite
8	Bonnet	A105N	A350-LF2	A182-F5	A182-F9	A182-F11	A182-F22	A182-F316/F316L
9	Body Bolt	A193-B7	A320-L7	A193-B16				A193-B8M
10	Nameplate	Aluminum						
11	Rivet	A276-410						

DIMENSIONS AND WEIGHTS

SIZE		AT	AS	AF-150	AF-300	AF-600	B (Min)	C	D (Min)	H	WGT.			
											150	300	600	800
1/2	Inch	3.11	3.11	4.25	5.98	6.50	0.37	0.87	0.51	2.40	10.1	10.6	12.8	3.75
	mm	79.0	79.0	108.0	152.0	165.0	9.50	22.0	13.0	61.0	4.60	4.80	5.80	1.70
3/4	Inch	4.37	4.37	4.61	7.01	7.48	0.49	1.08	0.71	3.07	18.8	19.4	20.9	7.28
	mm	111.0	111.0	117.0	178.0	190.0	12.5	27.4	18.0	78.0	8.50	8.80	9.50	3.30
1	Inch	4.72	4.72	5.00	8.50	8.50	0.49	1.34	0.94	3.31	20.3	21.2	22.9	9.26
	mm	120.0	120.0	127.0	216.0	216.0	12.5	34.1	24.0	84.0	9.20	9.60	10.4	4.20
1-1/4	Inch	4.72	4.72	5.51	9.02	9.02	0.49	1.69	1.14	3.31	27.6	30.2	34.4	9.26
	mm	120.0	120.0	140.0	229.0	229.0	12.5	42.9	29.0	84.0	12.5	13.7	15.6	4.20
1-1/2	Inch	5.51	5.51	6.50	9.49	9.49	0.49	1.93	1.42	4.72	32.6	39.2	54.0	18.7
	mm	140.0	140.0	165.0	241.0	241.0	12.5	49.0	36.5	120.0	14.8	17.8	24.5	8.50
2	Inch	6.30	6.30	7.99	10.5	11.5	0.63	2.42	1.75	5.51	42.6	59.2	74.0	28.7
	mm	160.0	160.0	203.0	267.0	292.0	16.0	61.5	44.5	140.0	19.4	26.9	33.6	13.0

(713) 673-2073 – Fax (713) 673-4641 - Toll Free (866) GO-BERIC (462-3742)

www.bericvalves.com

Gate Valve Full Port, Welded Bonnet Forged Steel

515 SERIES

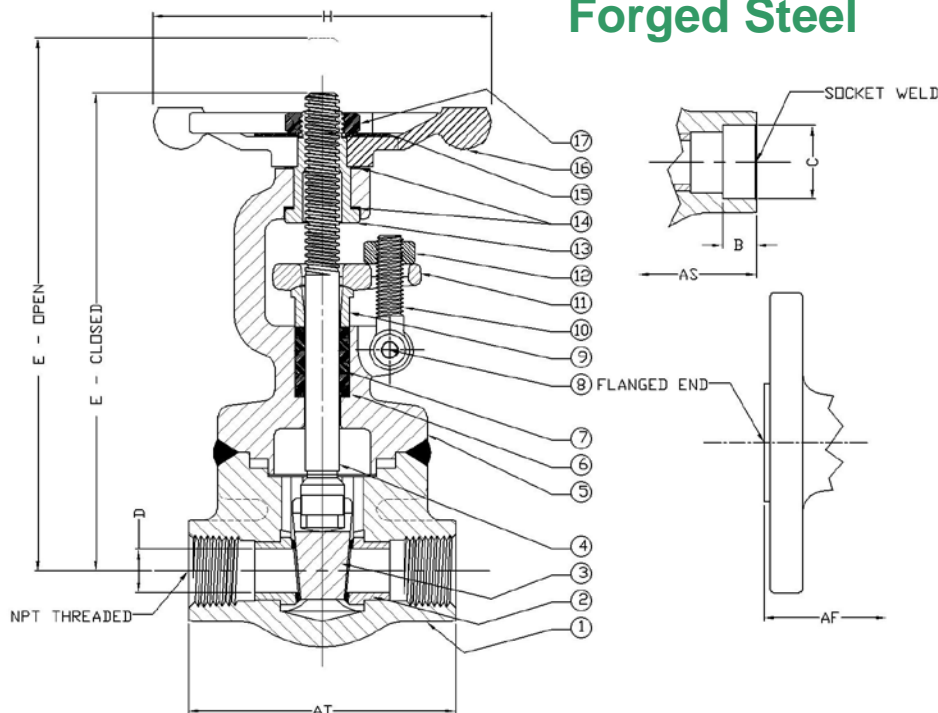

STANDARDS

DESIGN:

API 602
ASME B16.34

TESTING:

API 598

PRESSURE CLASS:

NPT & SW – 800
FLANGED – 150,300,600

CONNECTIONS:

NPT – ASME B1.20.1
SW - ASME B16.11
FLANGED – ASME B16.5
ASME B16.10

MATERIAL LIST								
NO.	Part Name	A105	LF2	F5	F9	F11	F22	F316/F316L
1	Body	A105N	A350-LF2	A182-F5	A182-F9	A182-F11	A182-F22	A182-F316/F316L
2	Seat Ring	A276-410/CoCr-A						A276-316/CoCr-A
3	Gate	A276-420						A276-316
4	Stem	A276-410						A276-316
5	Bonnet	A105N	A350-LF2	A182-F5	A182-F9	A182-F11	A182-F22	A182-F316/F316L
6	Wiper Ring	Braided Graphite						
7	Packing	Die Formed Graphite						
8	Eyebolt Pin	A276-410						A276-316
9	Gland	A276-420						A276-316
10	Eyebolt	A193-B7	A320-L7	A193-B16				A193-B8M
11	Gland Plate	A105						A182-F316
12	Gland Nut	A194-2H	A194-4	A194-7				
13	Op Nut	A276-410						A276-410
14	Washer	A276-410						
15	Nameplate	Aluminum						
16	Handwheel	A197						
17	Handwheel Nut	A108-1020						A194-8

SIZE	DIMENSIONS AND WEIGHTS											WGT.				
	AT	AS	AF-150	AF-300	AF-600	B(Min)	C	D (Min)	EO	EC	H	150	300	600	800	
1/2	Inch	3.11	3.11	4.25	5.51	6.50	0.37	0.87	0.51	6.26	5.63	3.94	8.77	10.8	12.8	3.75
	mm	79.0	79.0	108.0	140.0	165.0	9.50	22.0	13.0	159.0	143.0	100.0	3.98	4.89	5.80	1.70
3/4	Inch	4.37	4.37	4.61	5.98	7.48	0.49	1.08	0.71	7.80	7.01	4.72	13.5	15.9	19.4	8.38
	mm	111.0	111.0	117.0	152.0	190.0	12.5	27.4	18.0	198.0	178.0	120.0	6.12	7.23	8.80	3.80
1	Inch	4.72	4.72	5.00	6.50	8.50	0.49	1.34	.94	9.06	9.45	6.30	19.9	23.3	29.5	12.3
	mm	120.0	120.0	127.0	165.0	216.0	12.5	34.1	24.0	230.0	240.0	160.0	9.04	10.6	13.4	5.60
1-1/4	Inch	4.72	4.72	5.51	7.01	9.02	0.49	1.69	1.14	9.61	8.39	6.30	22.9	27.9	34.4	14.1
	mm	120.0	120.0	140.0	178.0	229.0	12.5	42.9	29.0	244.0	213.0	160.0	10.4	12.6	15.6	6.40
1-1/2	Inch	5.51	5.51	6.50	7.48	9.49	0.49	1.93	1.44	11.2	11.2	8.66	34.2	39.7	43.0	22.0
	mm	140.0	140.0	165.0	190.0	241.0	12.5	49.0	36.5	284.0	285.0	220.0	15.5	18.0	19.5	10.0
2	Inch	6.30	6.30	7.01	8.50	11.5	0.63	2.42	1.75	13.0	11.1	8.66	47.4	52.9	56.2	30.9
	mm	160.0	160.0	178.0	216.0	292.0	16.0	61.5	44.5	330.0	283.0	220.0	21.5	24.0	25.5	14.0

(713) 673-2073 – Fax (713) 673-4641 - Toll Free (866) GO-BERIC (462-3742)

www.bericvalves.com

Globe Valve Full Port, Welded Bonnet Forged Steel

516 SERIES

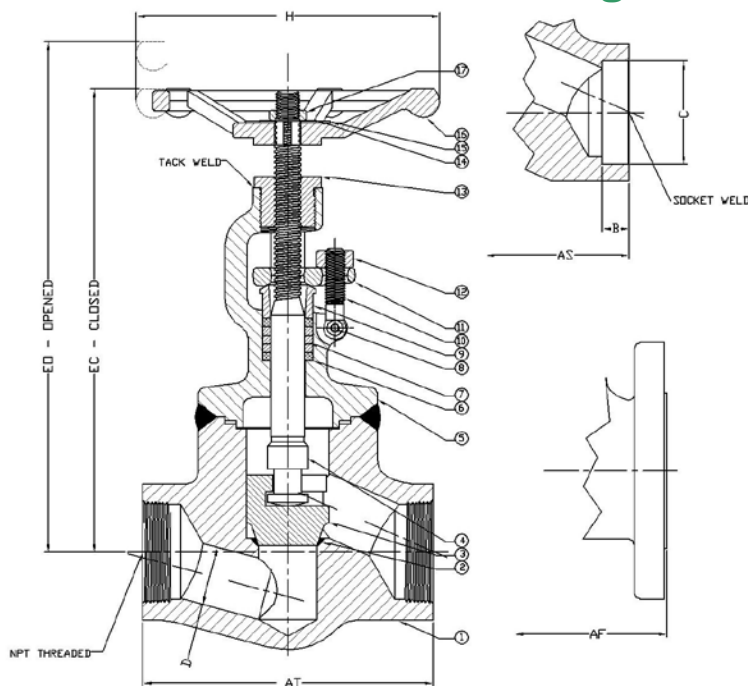

STANDARDS

DESIGN:

API 602
MSS SP-118
ASME B16.34

TESTING:

API 598

PRESSURE CLASS:

NPT & SW – 800
FLANGED – 150,300,600

CONNECTIONS:

NPT – ASME B1.20.1
SW - ASME B16.11
FLANGED – ASME B16.5
ASME B16.10

MATERIAL LIST								
NO.	Part Name	A105	LF2	F5	F9	F11	F22	F316/F316L
1	Body	A105N	A350-LF2	A182-F5	A182-F9	A182-F11	A182-F22	A182-F316/F316L
2	Seat Ring	CoCr-A						A276-316/CoCr-A
3	Disc	A276-420						A276-316
4	Stem	A276-410						A276-316
5	Bonnet	A105N	A350-LF2	A182-F5	A182-F9	A182-F11	A182-F22	A182-F316/F316L
6	Wiper Ring	Braided Graphite						
7	Packing	Die Formed Graphite						
8	Eyebolt Pin	A276-410						A276-316
9	Gland	A276-420						A276-316
10	Eyebolt	A193-B7	A320-L7	A193-B16		A193-B8M		
11	Gland Plate	A105						A182-F316
12	Gland Nut	A194-2H	A194-4	A194-7		A194-8M		
13	Op Nut	A276-410						A276-410
14	Washer	A276-410						
15	Nameplate	Aluminum						
16	Handwheel	A197						
17	Handwheel Nut	A194-2H						A194-8

DIMENSIONS AND WEIGHTS												WGT.				
SIZE		AT	AS	AF-150	AF-300	AF-600	B(Min)	C	D (Min)	EO	EC	H	150	300	600	800
1/2	Inch	3.11	3.11	4.25	5.98	6.50	0.37	0.87	0.51	6.54	6.10	3.94	8.82	11.2	17.2	5.22
	mm	79.0	79.0	108.0	152.0	165.0	9.50	22.0	13.0	166.0	155.0	100.0	4.00	5.10	7.80	2.37
3/4	Inch	4.37	4.37	4.61	7.01	7.48	0.49	1.08	0.71	8.07	7.60	3.94	13.7	15.9	27.6	9.48
	mm	111.0	111.0	117.0	178.0	190.0	12.5	27.4	18.0	205.0	193.0	100.0	6.19	7.20	12.5	4.30
1	Inch	4.72	4.72	5.00	7.99	8.50	0.49	1.34	0.87	9.45	8.66	4.72	21.2	25.3	37.5	17.2
	mm	120.0	120.0	127.0	203.0	216.0	12.5	34.1	22.0	240.0	220.0	120.0	9.60	11.5	17.0	7.80
1-1/4	Inch	5.98	5.98	5.51	8.50	9.02	0.49	1.69	1.18	9.88	9.13	6.30	23.2	29.8	51.8	17.2
	mm	152.0	152.0	140.0	216.0	229.0	12.5	42.9	30.0	251.0	232.0	160.0	10.5	13.5	23.5	7.80
1-1/2	Inch	6.77	6.77	6.50	9.01	9.49	0.49	1.93	1.42	11.4	10.6	7.09	37.5	43.4	85.5	27.6
	mm	172.0	172.0	165.0	229.0	241.0	12.5	49.0	36.0	290.0	268.0	180.0	17.0	19.7	38.8	12.5
2	Inch	8.66	8.66	7.99	10.5	11.5	0.63	2.42	1.81	14.0	9.57	8.66	48.5	54.5	96.6	38.6
	mm	220.0	220.0	203.0	267.0	292.0	16.0	61.5	46.0	355.0	243.0	220.0	22.0	24.7	43.8	17.5

(713) 673-2073 – Fax (713) 673-4641 - Toll Free (866) GO-BERIC (462-3742)

www.bericvalves.com

Piston Check Valve

Full Port, Welded Bonnet Forged Steel

517 SERIES

STANDARDS

DESIGN:

API 602
MSS SP-118
ASME B16.34

TESTING:

API 598

PRESSURE CLASS:

NPT & SW – 800
FLANGED – 150,300,600

CONNECTIONS:

NPT – ASME B1.20.1
SW - ASME B16.11
FLANGED – ASME B16.5
ASME B16.10

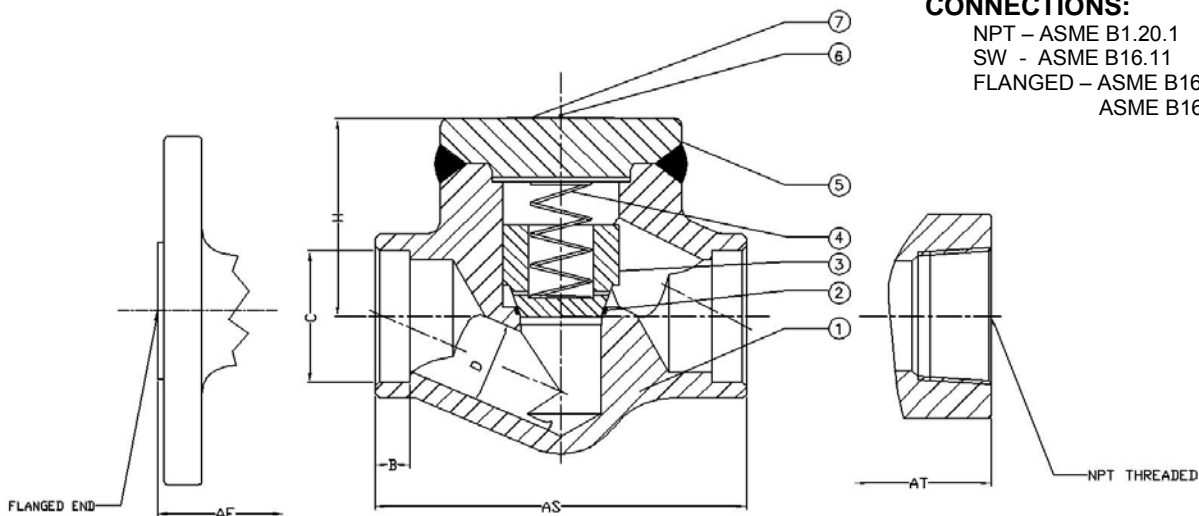

MATERIAL LIST								
NO.	Part Name	A105	LF2	F5	F9	F11	F22	F316/F316L
1	Body	A105N	A350-LF2	A182-F5	A182-F9	A182-F11	A182-F22	A182-F316/F316L
2	Seat Ring	CoCr-A						A182-F316/F316L
3	Disc	A276-420						316/CoCr-A
4	Spring	A276-316						
5	Bonnet	A105N	A350-LF2	A182-F5	A182-F9	A182-F11	A182-F22	A182-F316/F316L
6	Rivet	A276-410						
7	Nameplate	Aluminum						

DIMENSIONS AND WEIGHTS

SIZE		AT	AS	AF-150	AF-300	AF-600	B(Min)	C	D (Min)	H	WGT.			
											150	300	600	800
1/2	Inch	3.11	3.11	4.25	5.98	6.50	0.37	0.87	0.49	2.40	10.1	10.6	12.8	3.75
	mm	79.0	79.0	108.0	152.0	165.0	9.50	22.0	12.5	61.0	4.60	4.80	5.80	1.70
3/4	Inch	4.37	4.37	4.61	7.00	7.48	0.49	1.07	0.69	3.07	18.8	19.4	20.9	7.28
	mm	111.0	111.0	117.0	178.0	190.0	12.5	27.4	17.5	78.0	8.50	8.80	9.50	3.30
1	Inch	4.72	4.72	5.00	8.50	8.50	0.49	1.34	0.89	3.31	20.3	21.2	22.9	9.26
	mm	120.0	120.0	127.0	216.0	216.0	12.5	34.1	22.5	84.0	9.20	9.60	10.4	4.20
1-1/4	Inch	5.98	5.98	5.51	9.02	9.02	0.49	1.68	1.12	3.31	27.6	30.2	34.4	9.26
	mm	152.0	152.0	140.0	229.0	229.0	12.5	42.9	28.5	84.0	12.5	13.7	15.6	4.20
1-1/2	Inch	6.77	6.77	6.50	9.50	9.49	0.49	1.93	1.40	4.72	32.6	39.2	54.0	18.7
	mm	172.0	172.0	165.0	241.0	241.0	12.5	49.0	35.5	120.0	14.8	17.8	24.5	8.50
2	Inch	8.66	8.66	7.99	10.5	11.5	0.63	2.41	1.75	5.51	42.6	59.2	74.0	28.7
	mm	220.0	220.0	203.0	267.0	292.0	16.0	61.5	44.5	140.0	19.4	26.9	33.6	13.0

(713) 673-2073 – Fax (713) 673-4641 - Toll Free (866) GO-BERIC (462-3742)

www.bericvalves.com

Swing Check Valve Full Port, Welded Bonnet Forged Steel

518 SERIES

STANDARDS

DESIGN:

API 602
MSS SP-118
ASME B16.34

TESTING:

API 598

PRESSURE CLASS:

NPT & SW – 800
FLANGED – 150,300,600

CONNECTIONS:

NPT – ASME B1.20.1
SW - ASME B16.11
FLANGED – ASME B16.5
ASME B16.10

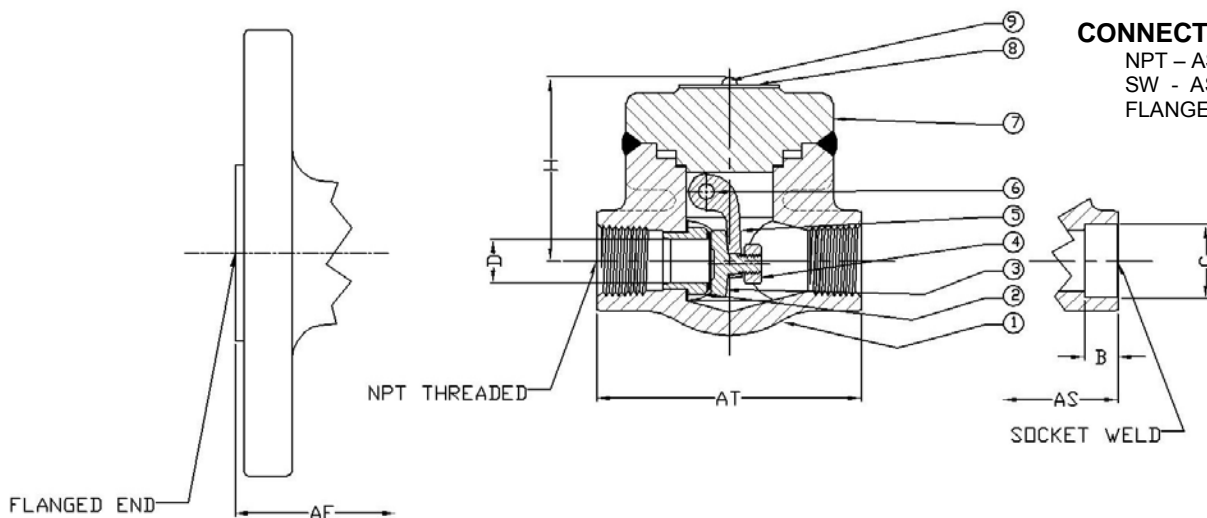

MATERIAL LIST								
NO.	Part Name	A105	LF2	F5	F9	F11	F22	F316/F316L
1	Body	A105N	A350-LF2	A182-F5	A182-F9	A182-F11	A182-F22	A182-F316/F316L
2	Seat Ring	A276-410/CoCr-A						316/CoCr-A
3	Disc	A276-410						A276-316
4	Disc Nut	A194-8						A194-8M
5	Swing Arm	A276-316						A351-CF8M
6	Hinge Pin	A276-316						
7	Bonnet	A105N	A350-LF2	A182-F5	A182-F9	A182-F11	A182-F22	A182-F316/F316L
8	Nameplate	Aluminum						
9	Rivet	A276-410						

DIMENSIONS AND WEIGHTS

SIZE		AT	AS	AF-150	AF-300	AF-600	B	C	D (Min)	H	WGT.			
											150	300	600	800
1/2	Inch	3.62	3.62	4.25	5.98	6.50	0.37	0.87	0.51	2.40	10.1	10.6	12.8	3.75
	mm	92.0	92.0	108.0	152.0	165.0	9.50	22.0	13.0	61.0	4.60	4.80	5.80	1.70
3/4	Inch	4.37	4.37	4.60	7.01	7.48	0.49	1.08	0.71	3.07	18.8	19.4	20.9	7.28
	mm	111.0	111.0	117.0	178.0	190.0	12.5	27.4	18.0	78.0	8.50	8.80	9.50	3.30
1	Inch	4.72	4.72	5.00	8.50	8.50	0.49	1.34	0.94	3.31	20.3	21.2	22.9	9.26
	mm	120.0	120.0	127.0	216.0	216.0	12.5	34.1	24.0	84.0	9.20	9.60	10.4	4.20
1-1/4	Inch	4.72	4.72	5.51	9.02	9.02	0.49	1.69	1.14	3.31	27.6	30.2	34.4	9.26
	mm	120.0	120.0	140.0	229.0	229.0	12.5	42.9	29.0	84.0	12.5	13.7	15.6	4.20
1-1/2	Inch	5.51	5.51	6.50	9.49	9.49	0.49	1.93	1.42	4.72	32.6	39.2	54.0	18.7
	mm	140.0	140.0	165.0	241.0	241.0	12.5	49.0	36.0	120.0	14.8	17.8	24.5	8.50
2	Inch	5.91	5.91	7.99	10.5	11.5	0.63	2.42	1.98	5.51	42.6	59.2	74.0	28.7
	mm	150.0	150.0	203.0	267.0	292.0	16.0	61.5	50.4	140.0	19.4	26.9	33.6	13.0

(713) 673-2073 – Fax (713) 673-4641 - Toll Free (866) GO-BERIC (462-3742)

www.bericvalves.com

Y-Pattern Globe Valve Bolted Bonnet, Class 1500 Forged Steel

509 SERIES

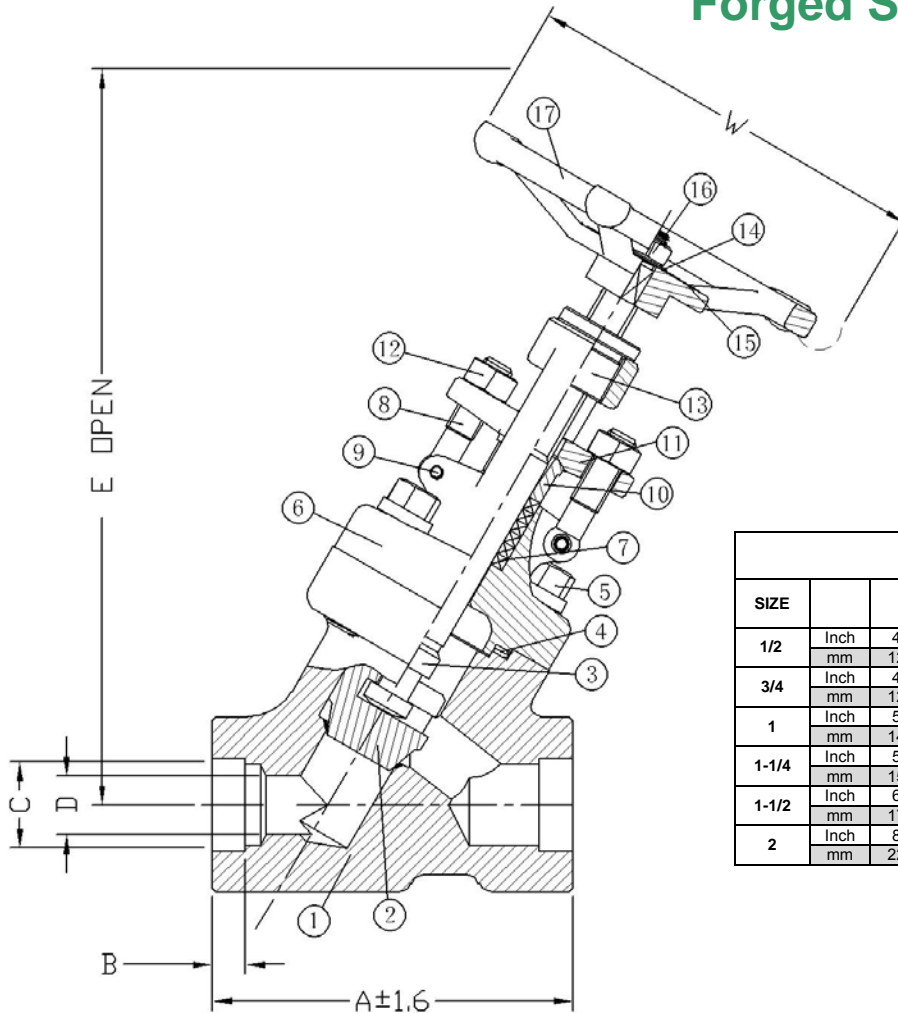

STANDARDS:

DESIGN:

API 602
ASME B16.34

TESTING:

API 598

PRESSURE CLASS:

NPT, SW, & BW – 1500

CONNECTIONS:

NPT – ASME B1.20.1
SW – ASME B16.11
BW – ASME B16.25

DIMENSIONS AND WEIGHTS

SIZE		A	B (Min)	C	D (Min)	E	W	WGT.
1/2	Inch	4.72	0.37	0.87	0.37	8.94	4.72	11.0
	mm	120.0	9.50	22.0	9.50	227.0	120.0	5.00
3/4	Inch	4.72	0.49	1.08	0.37	8.94	4.72	10.8
	mm	120.0	12.5	27.4	9.50	227.0	120.0	4.90
1	Inch	5.51	0.49	1.34	0.59	10.4	6.30	15.7
	mm	140.0	12.5	34.1	15.0	265.0	160.0	7.10
1-1/4	Inch	5.98	0.49	1.69	0.87	11.2	6.30	19.6
	mm	152.0	12.5	42.9	22.0	284.0	160.0	8.90
1-1/2	Inch	6.77	0.49	1.93	1.02	13.7	8.66	33.0
	mm	172.0	12.5	49.0	26.0	348.0	220.0	15.0
2	Inch	8.66	0.63	2.42	1.12	14.0	8.66	48.5
	mm	220.0	16.0	61.5	28.5	355.0	220.0	22.0

MATERIAL LIST							
NO.	Part Name	A105	LF2	F91	F11	F22	F316/F316L
1	Body	A105N	A350-LF2	A182-F91	A182-F11	A182-F22	A182-F316/F316L
2	Disc			A276-420			316/CoCr-A
3	Stem			A276-410			A276-316
4	Gasket			304/Graphite			316/Graphite
5	Body Bolts	A193-B7	A320-L7	A193-B16			A193-B8M
6	Bonnet	A105N	A350-LF2	A182-F91	A182-F11	A182-F22	A194-316
7	Packing			Graphite			
8	Eyebolt	A193 B7	A320 L7	A193 B16	A193 B16	A193 B16	A193 B8M
9	Eyebolt Pin			A276-304			A276-316
10	Gland	A276-420	A276-420	A276-420	A276-420	A276-420	A276-316
11	Gland Plate	A105N	A105N	A105N	A105N	A105N	A182-F316/F316L
12	Eyebolt Nut	A194-2H	A194-4	A194-7	A194-7	A194-7	A194-8M
13	Op-Nut			A276-410			
14	Lock Washer			Carbon Steel			
15	Nameplate			Aluminum			
16	Handwheel Nut			A194-2H			A194-8
17	Handwheel			ASTM A197			

(713) 673-2073 – Fax (713) 673-4641 - Toll Free (866) GO-BERIC (462-3742)

www.bericvalves.com

Y-Pattern Check Valve 510 SERIES

Bolted Bonnet, Class 1500

Forged Steel

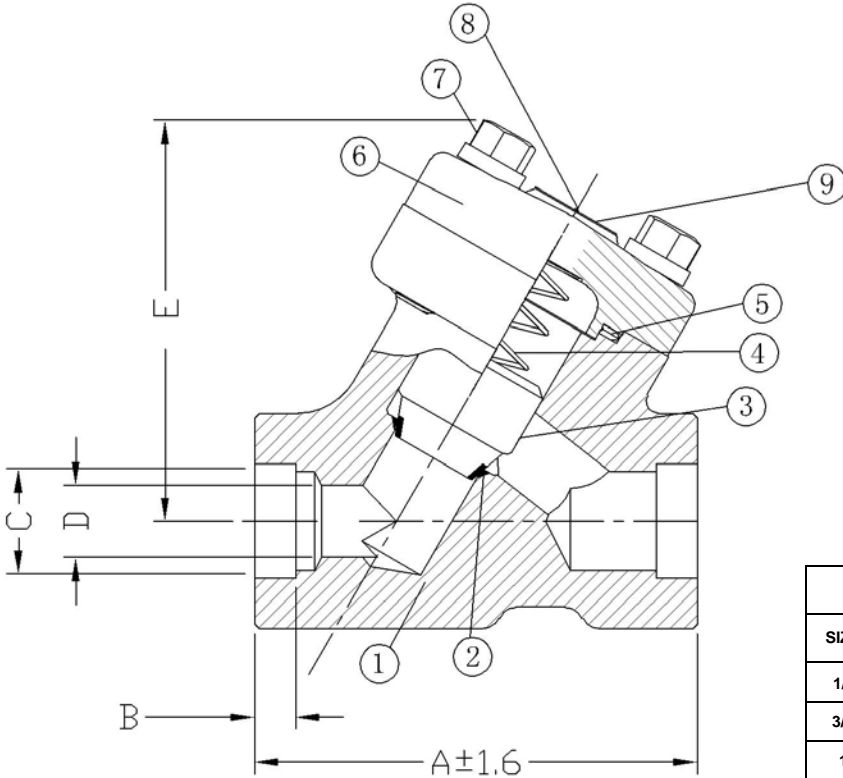

STANDARDS:

DESIGN:

API 602
ASME B16.34

TESTING:

API 598

PRESSURE CLASS:

NPT, SW, & BW – 1500

CONNECTIONS:

NPT – ASME B1.20.1
SW – ASME B16.11
BW – ASME B16.25

DIMENSIONS AND WEIGHTS

SIZE		A	B (Min)	C	D (Min)	E	WGT.
1/2	Inch	4.72	0.37	0.87	0.37	4.33	9.25
	mm	120.0	9.50	22.0	9.50	110.0	4.20
3/4	Inch	4.72	0.49	1.08	0.37	4.33	19.8
	mm	120.0	12.5	27.4	9.50	110.0	9.00
1	Inch	5.51	0.49	1.34	0.59	4.88	19.8
	mm	140.0	12.5	34.1	15.0	124.0	9.00
1-1/4	Inch	5.51	0.49	1.69	0.87	5.43	33.0
	mm	140.0	12.5	42.9	22.0	138.0	15.0
1-1/2	Inch	6.77	0.49	1.93	1.02	6.50	33.1
	mm	172.0	12.5	49.0	26.0	165.0	15.0
2	Inch	8.66	0.63	2.42	1.10	6.69	39.7
	mm	220.0	16.0	61.5	28.0	170.0	18.0

MATERIAL LIST

NO.	Part Name	A105	LF2	F5	F9	F11	F22	F316/F316L
1	Body	A105N	A350-LF2	A182-F5	A182-F9	A182-F11	A182-F22	A182-F316/F316L
2	Seat Ring	CoCr-A						316/CoCr-A
3	Disc	A276-420						
4	Spring	A276-316						
5	Gasket	Spiral Wound 304/Graphite						316/Graphite
6	Bonnet	A105N	A350-LF2	A182-F5	A182-F9	A182-F11	A182-F22	A182-F316/F316L
7	Body Bolt	A193-B7	A320-L7	A193-B16			A193-B8M	
8	Rivet	A276-410						
9	Nameplate	Aluminum						

Y-Pattern Globe Valve Welded Bonnet, Class 1500 Forged Steel

512 SERIES

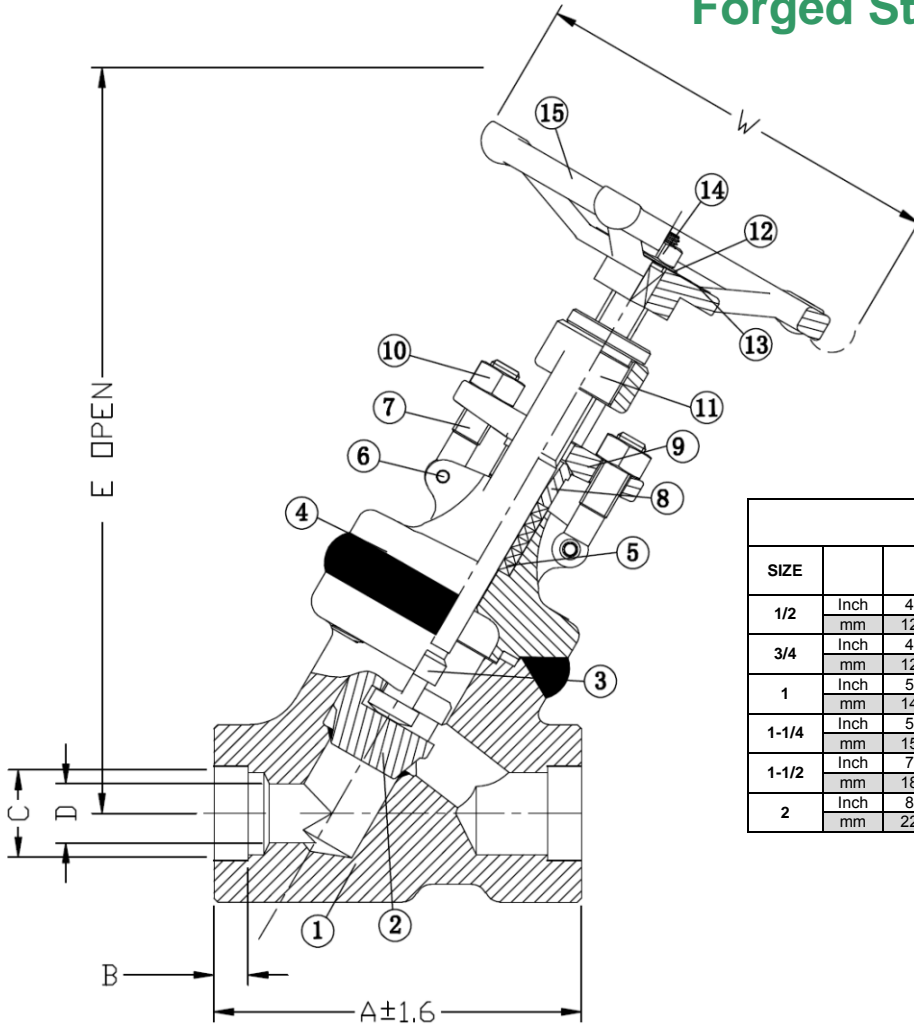

STANDARDS:

DESIGN:

API 602
ASME B16.34

TESTING:

API 598

PRESSURE CLASS:

NPT, SW, & BW – 1500

CONNECTIONS:

NPT – ASME B1.20.1
SW – ASME B16.11
BW – ASME B16.25

DIMENSIONS AND WEIGHTS								
SIZE		A	B (Min)	C	D (Min)	E	W	WGT.
1/2	Inch	4.72	0.37	0.87	0.37	6.89	4.92	10.1
	mm	120.0	9.50	22.0	9.50	175.0	125.0	4.60
3/4	Inch	4.72	0.49	1.08	0.37	8.46	4.92	10.1
	mm	120.0	12.5	27.4	9.50	215.0	125.0	4.60
1	Inch	5.51	0.49	1.34	0.59	8.46	6.30	20.5
	mm	140.0	12.5	34.1	15.0	215.0	160.0	9.30
1-1/4	Inch	5.98	0.49	1.69	0.87	10.0	6.30	20.5
	mm	152.0	12.5	42.9	22.0	254.0	160.0	9.30
1-1/2	Inch	7.08	0.49	1.93	1.02	12.0	8.66	30.9
	mm	180.0	12.5	49.0	26.0	305.0	220.0	14.0
2	Inch	8.86	0.63	2.42	1.12	13.5	8.66	43.0
	mm	225.0	16.0	61.5	28.5	343.0	220.0	19.6

MATERIAL LIST								
NO.	Part Name	A105	LF2	F91	F11	F22	F316/F316L	
1	Body	A105N	A350-LF2	A182-F91	A182-F11	A182-F22	A182-F316/F316L	
2	Disc	ASTM A276-420					A276-316	316/CoCr-A
3	Stem	A276-410					A276-316	
4	Bonnet	A105N	A350-LF2	A182-F91	A182-F11	A182-F22	A194-316	
5	Packing	Graphite						
6	Eyebolt Pin	A276 304					A276-316	
7	Eyebolt	A193-B7	A320-L7	A193 B16	A193-B16	A193-B16	A193-B8M	
8	Gland	A276-420	A276-420	A276-420	A276-420	A276-420	A276-420	
9	Gland Plate	A105N	A105N	A105N	A105N	A105N	A182-F316/F316L	
10	Eyebolt Nut	A194-2H	A194-4	A194-7	A194-7	A194-7	A194-8M	
11	Op-Nut	A276-410						
12	Lock Washer	Carbon Steel						
13	Nameplate	Aluminum						
14	Handwheel Nut	A194-2H					A194-8	
15	Handwheel	ASTM A197						

Y-Pattern Globe Valve 512 SERIES

Welded Bonnet, Class 2500

Forged Steel

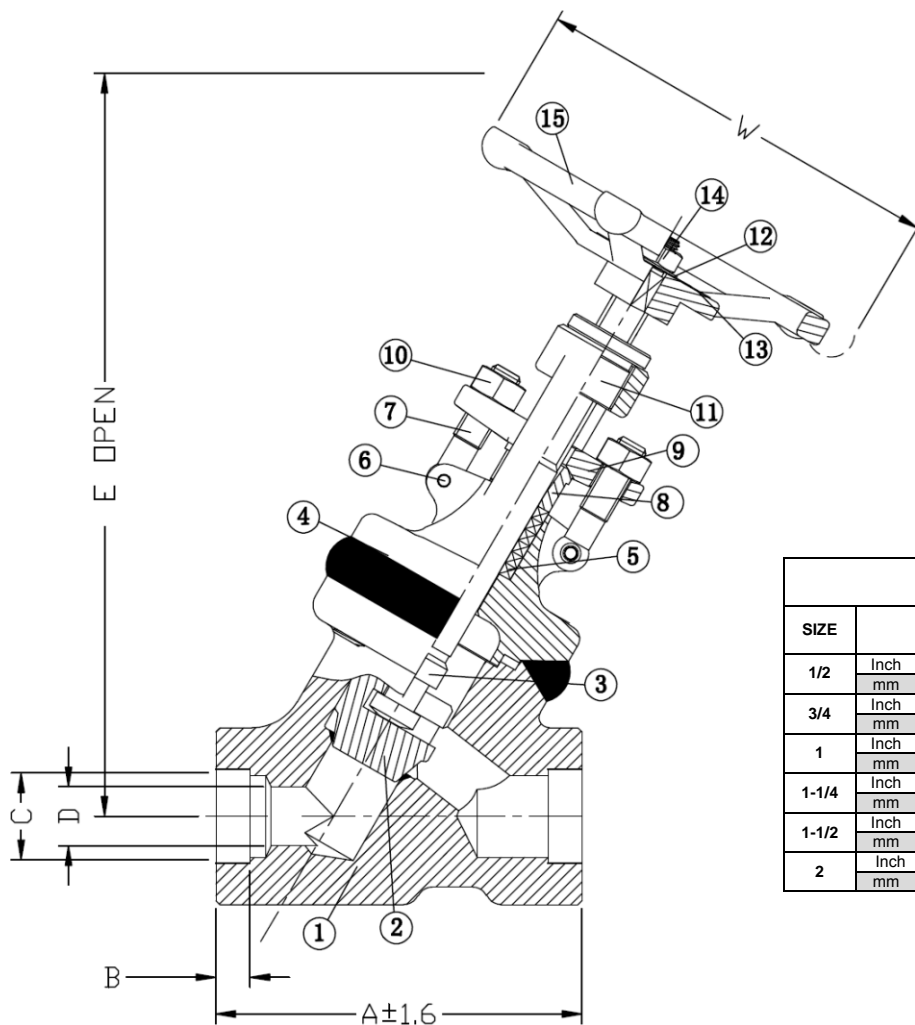

STANDARDS:

DESIGN:

API 602
ASME B16.34

TESTING:

API 598

PRESSURE CLASS:

NPT, SW, & BW – 2500

CONNECTIONS:

NPT – ASME B1.20.1
SW – ASME B16.11
BW – ASME B16.25

DIMENSIONS AND WEIGHTS

SIZE		A	B (Min)	C	D (Min)	E	W	WGT.
1/2	Inch	7.32	0.37	0.87	0.43	13.0	7.87	27.1
	mm	186.0	9.50	22.0	11.0	329.0	200.0	12.3
3/4	Inch	7.32	0.49	1.08	0.56	13.0	7.87	25.6
	mm	186.0	12.5	27.4	14.0	329.0	200.0	11.6
1	Inch	7.32	0.49	1.34	0.75	13.0	7.87	23.8
	mm	186.0	12.5	34.1	19.0	329.0	200.0	10.8
1-1/4	Inch	9.13	0.49	1.69	0.98	13.8	11.02	61.7
	mm	232.0	12.5	42.9	25.0	350.0	280.0	28.0
1-1/2	Inch	9.13	0.49	1.93	1.12	13.8	11.02	58.2
	mm	232.0	12.5	49.0	28.0	350.0	280.0	26.4
2	Inch	12.2	0.63	2.42	1.38	15.1	11.81	96.6
	mm	310.0	16.0	61.5	35.0	383.0	300.0	43.8

MATERIAL LIST								
NO.	Part Name	A105	LF2	F91	F11	F22	F316/F316L	
1	Body	A105N	A350-LF2	A182-F91	A182-F11	A182-F22	A182-F316/F316L	
2	Disc	ASTM A276-420					316/CoCr-A	
3	Stem	A276-410						A276-316
4	Bonnet	A105N	A350-LF2	A182-F91	A182-F11	A182-F22	A194-316	
5	Packing	Graphite						
6	Eyebolt Pin	A276-304					A276-316	
7	Eyebolt	A193-B7	A320-L7	A193-B16	A193-B16	A193-B16	A193-B8M	
8	Gland	A276-420	A276-420	A276-420	A276-420	A276-420	A276-316	
9	Gland Plate	A105N	A105N	A105N	A105N	A105N	A182-F316/F316L	
10	Eyebolt Nut	A194-2H	A194-4	A194-7	A194-7	A194-7	A194-8M	
11	Op-Nut	A276-410						
12	Lock Washer	Carbon Steel						
13	Nameplate	Aluminum						
14	Handwheel Nut	A194-2H					A194-8	
15	Handwheel	ASTM A197						

(713) 673-2073 – Fax (713) 673-4641 - Toll Free (866) GO-BERIC (462-3742)

www.bericvalves.com

Copyright 2015

Page 24FS

Y-Pattern Check Valve 513 SERIES

Welded Bonnet, Class 1500

Forged Steel

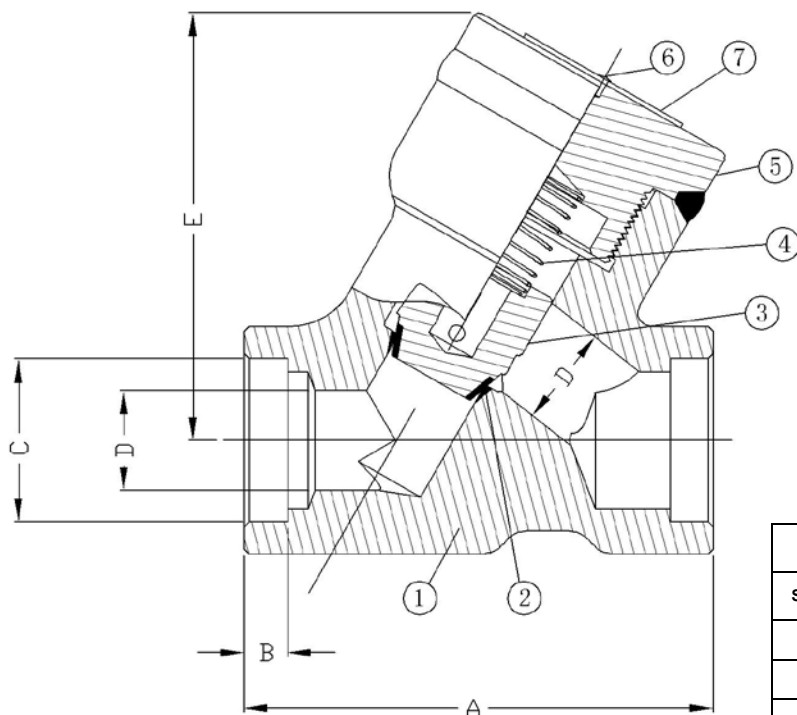

STANDARDS:

DESIGN:

API 602
ASME B16.34

TESTING:

API 598

PRESSURE CLASS:

NPT, SW, & BW – 1500

CONNECTIONS:

NPT – ASME B1.20.1
SW – ASME B16.11
BW – ASME B16.25

DIMENSIONS AND WEIGHTS							
SIZE		A	B (Min)	C	D (Min)	E	WGT.
1/2	Inch	4.72	0.37	0.87	0.37	2.76	9.25
	mm	120.0	9.50	22.0	9.50	70.0	4.2
3/4	Inch	4.72	0.49	1.08	0.37	3.94	19.8
	mm	120.0	12.5	27.4	9.50	100.0	9.0
1	Inch	5.51	0.49	1.34	0.59	4.33	19.8
	mm	140.0	12.5	34.1	15.0	110.0	9.0
1-1/4	Inch	5.98	0.49	1.69	0.87	4.33	33.1
	mm	152.0	12.5	42.9	22.0	110.0	15.0
1-1/2	Inch	7.09	0.49	1.93	1.02	4.72	33.1
	mm	180.0	12.5	49.0	26.0	120.0	15.0
2	Inch	8.86	0.63	2.42	1.12	5.91	39.7
	mm	225.0	16.0	61.5	28.5	150.0	18.0

MATERIAL LIST								
NO.	Part Name	A105	LF2	F5	F9	F11	F22	F316/F316L
1	Body	A105N	A350-LF2	A182-F5	A182-F9	A182-F11	A182-F22	A182-F316/F316L
2	Seat Ring	CoCr-A						316/CoCr-A
3	Disc	A276-420						A276-316
4	Spring	A276-316						
5	Bonnet	A105N	A350-LF2	A182-F5	A182-F9	A182-F11	A182-F22	A182-F316/F316L
6	Rivet	A276-410						
7	Nameplate	Aluminum						

Extended Body Gate Valve Standard Port Forged Steel

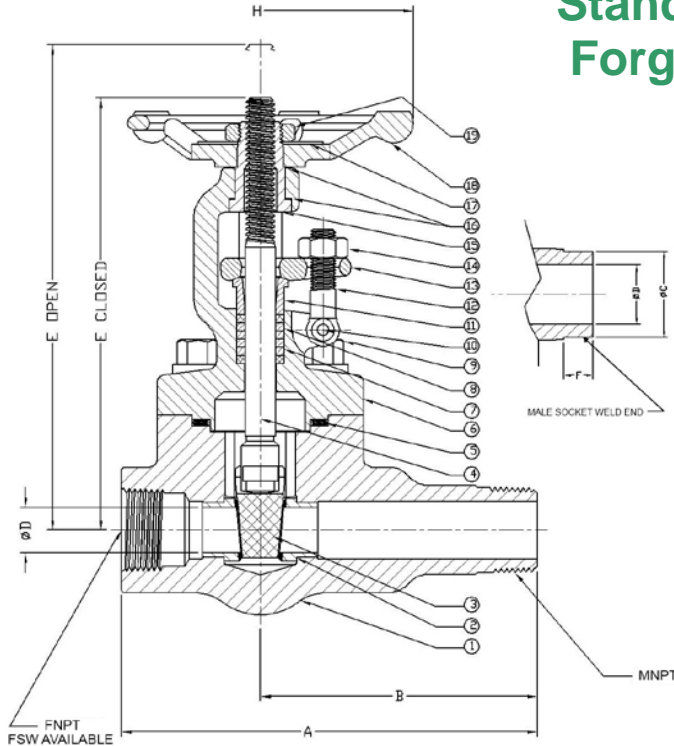

501 series with extended body.
Please refer to the End Connection
section of the Figure Number
Chart for various options.

STANDARDS

DESIGN:

API 602
ASME B16.34

TESTING:

API 598

PRESSURE CLASS:

NPT, SW & BW – 800

CONNECTIONS:

NPT – ASME B1.20.1
SW - ASME B16.11
Butt Weld – ASME B16.25

		MATERIAL LIST						
NO.	Part Name	A105	LF2	F5	F9	F11	F22	F316/F316L
1	Body	A105N	A350-LF2	A182-F5	A182-F9	A182-F11	A182-F22	A182-F316/F316L
2	Seat Ring	A276-410/CoCr-A						A276-316/CoCr-A
3	Gate	A276-420						A276-316
4	Stem	A276-410						A276-316
5	Gasket	Spiral Wound 304/Graphite						316/Graphite
6	Bonnet	A105N	A350-LF2	A182-F5	A182-F9	A182-F11	A182-F22	A182-F316/F316L
7	Wiper Ring	Braided Graphite						
8	Packing	Die Formed Graphite						
9	Body Bolt	A193-B7	A320-L7	A193-B16				A193-B8M
10	Eyebolt Pin	A276-304						A276-316
11	Gland	A276-420						A276-316
12	Eyebolt	A193-B7	A320-L7	A193-B16				A193-B8M
13	Gland Plate	A105						A182-F316
14	Gland Nut	A194-2H	A194-4	A194-7				
15	Op Nut	A276-410						A276-316
16	Washer	A276-410						
17	Nameplate	Aluminum						
18	Handwheel	A197						
19	Handwheel Nut	A108-1020						A194-8

SIZE		A	B	C	D (Min)	EO	EC	F	H	WEIGHT
1/2*	Inch	5.89	4.33	0.84	0.37	6.30	5.83	0.31	3.94	5.49
	mm	149.5	110.0	21.3	9.5	160.0	148.0	7.90	100.0	2.49
3/4	Inch	6.14	4.33	1.05	0.51	6.65	6.02	0.44	3.94	5.62
	mm	156.0	110.0	26.7	13.0	169.0	153.0	11.2	100.0	2.55
1	Inch	6.90	4.72	1.31	0.71	7.60	6.73	0.44	4.72	10.0
	mm	175.5	120.0	33.3	18.0	193.0	171.0	11.2	120.0	4.55
1-1/2	Inch	7.87	5.51	1.90	1.14	9.69	8.31	0.44	6.30	16.8
	mm	200.0	140.0	48.3	29.0	246.0	211.0	11.2	160.0	7.62
2	Inch	8.66	5.91	2.37	1.44	11.1	9.45	0.56	7.09	26.0
	mm	220.0	150.0	60.3	36.5	283.0	240.0	14.2	180.0	11.8

*1/2" MNPT VALVES ARE NOT RECOGNIZED BY API 602

Reinforced Extended Body Gate Valve

Standard Port Forged Steel

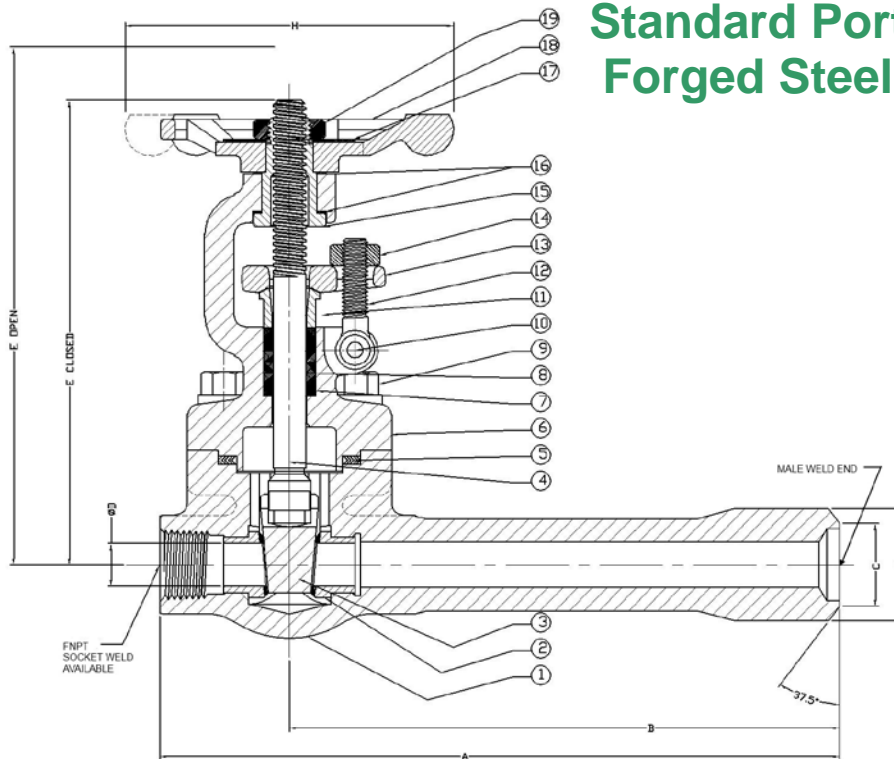

501 series with reinforced extended body. Please refer to the Options section of the Figure Number Chart for applicable code.

STANDARDS

DESIGN:

API 602
ASME B16.34

TESTING:

API 598

PRESSURE CLASS:

NPT, SW & BW – 800

CONNECTIONS:

NPT – ASME B1.20.1
SW - ASME B16.11
Butt Weld – ASME B16.25

MATERIAL LIST								
NO.	Part Name	A105	LF2	F5	F9	F11	F22	F316/F316L
1	Body	A105N	A350-LF2	A182-F5	A182-F9	A182-F11	A182-F22	A182-F316/F316L
2	Seat Ring	A276-410/CoCr-A						A276-316/CoCr-A
3	Gate	A276-420						A276-316
4	Stem	A276-410						A276-316
5	Gasket	Spiral Wound 304/Graphite						316/Graphite
6	Bonnet	A105N	A350-LF2	A182-F5	A182-F9	A182-F11	A182-F22	A182-F316/F316L
7	Wiper Ring	Braided Graphite						
8	Packing	Die Formed Graphite						
9	Body Bolt	A193-B7	A320-L7	A193-B16				A193-B8M
10	Eyebolt Pin	A276-304						A276-316
11	Gland	A276-420						A276-316
12	Eyebolt	A193-B7	A320-L7	A193-B16				A193-B8M
13	Gland Plate	A105						A182-F316
14	Gland Nut	A194-2H	A194-4	A194-7				
15	Op Nut	A276-410						A276-316
16	Washer	A276-410						
17	Nameplate	Aluminum						
18	Handwheel	A197						
19	Handwheel Nut	A108-1020						

DIMENSIONS AND WEIGHTS										
SIZE		A	B	C	D (Min)	EO	EC	F	H	WEIGHT
1/4"	Inch	8.15	6.59	0.99	0.37	6.30	5.83	1.34	3.94	6.70
	mm	207.0	167.5	25.2	9.50	160.0	148.0	34.0	100.0	3.04
3/4"	Inch	8.60	6.79	1.31	0.51	6.65	6.02	1.77	3.94	7.62
	mm	218.5	172.5	33.2	13.0	169.0	153.0	45.0	100.0	3.46
1"	Inch	9.63	7.44	1.52	0.71	7.60	6.73	2.05	4.72	13.1
	mm	244.5	189.0	38.7	18.0	193.0	171.0	52.0	120.0	5.92
1-1/2"	Inch	10.4	8.01	2.11	1.14	9.69	8.31	2.76	6.30	21.9
	mm	263.5	203.5	53.7	29.0	246.0	211.0	70.0	160.0	9.95
2"	Inch	10.5	7.78	2.69	1.44	11.1	9.45	3.35	8.66	33.3
	mm	267.5	197.5	68.2	36.5	283.0	240.0	85.0	220.0	15.1

Cryogenic Service Gate Valve Forged Steel

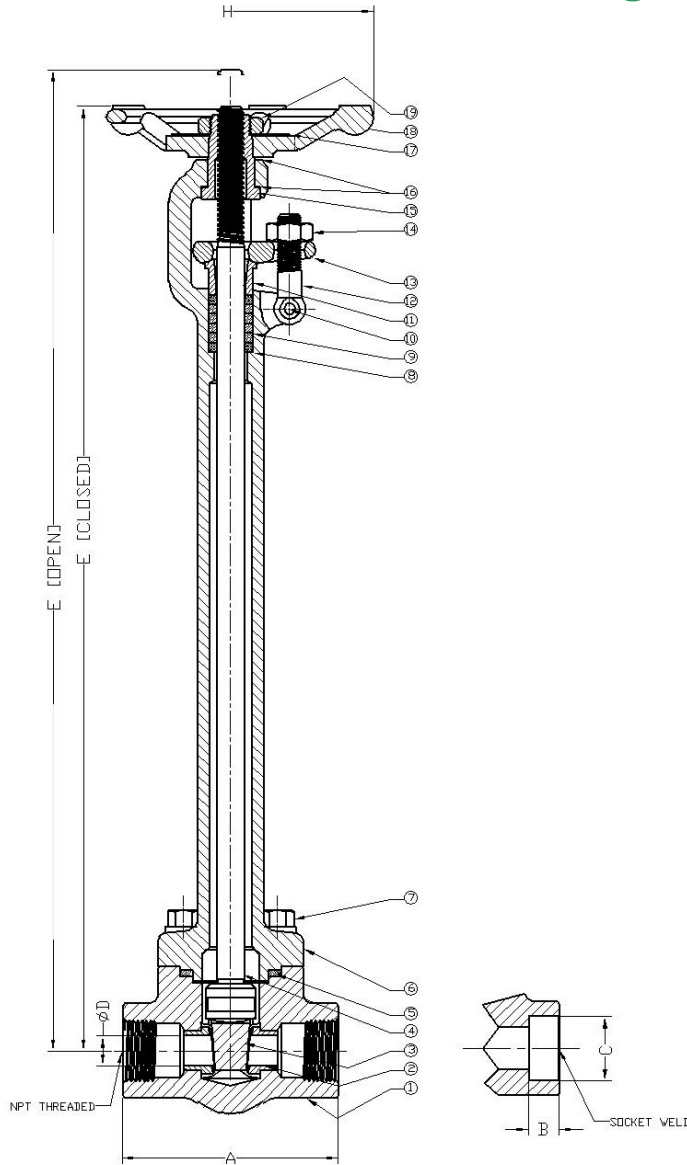

501 series with cryogenic extended bonnet.
Please refer to the Options section of the Figure Number Chart for applicable code.

STANDARDS

DESIGN:

API 602
ASME B16.34

TESTING:

API 598

PRESSURE CLASS:

NPT & SW – 800

CONNECTIONS:

NPT – ASME B1.20.1
SW - ASME B16.11

MATERIAL LIST		
NO.	Part Name	SPECIFICATION
1	Body	ASTM A182 Gr. F316/F316L
2	Seat Ring	ASTM A276 Gr. 316/CoCr-A
3	Gate	ASTM A276 Gr. 316
4	Stem	ASTM A276 Gr. 316
5	Gasket	Spiral Wound 316/Graphite
6	Bonnet	ASTM A182 Gr. F316/F316L
7	Body Bolt	ASTM A193 Gr. B8M
8	Wiper Rings	Braided Graphite
9	Packing	Die Formed Graphite
10	Eyebolt Pin	ASTM A276 Gr. 316
11	Gland	ASTM A276 Gr. 316
12	Eyebolt	ASTM A193 Gr. B8M
13	Gland Plate	ASTM A182 Gr. F316
14	Gland Nut	ASTM A194 Gr. 8M
15	Op Nut	ASTM A276 Gr. 316
16	Washer	ASTM A276 Gr. 410
17	Nameplate	Aluminum
18	Handwheel	A197
19	Handwheel Nut	A194-8

DIMENSIONS AND WEIGHTS								
SIZE		A	B (Min)	C	D (Min)	EO	EC	H
1/2	Inch	3.11	0.37	0.87	0.37	16.7	16.1	4.72
	mm	79.0	9.50	22.0	13.0	423.0	408.0	120.0
3/4	Inch	3.62	0.49	1.08	0.51	16.7	16.1	4.72
	mm	92.0	12.5	27.4	13.0	423.0	408.0	120.0
1	Inch	4.37	0.49	1.34	0.71	18.10	17.3	6.30
	mm	111.0	12.5	34.1	18.0	460.0	440.0	160.0
1-1/2	Inch	4.72	0.49	1.93	1.14	19.6	18.4	8.66
	mm	120.0	12.5	49.0	29.0	498.0	468.0	220.0
2	Inch	5.51	0.63	2.42	1.44	21.2	19.7	8.66
	mm	140.0	16.0	61.5	36.5	539.0	500.0	220.0

Cryogenic Service Globe Valve Forged Steel

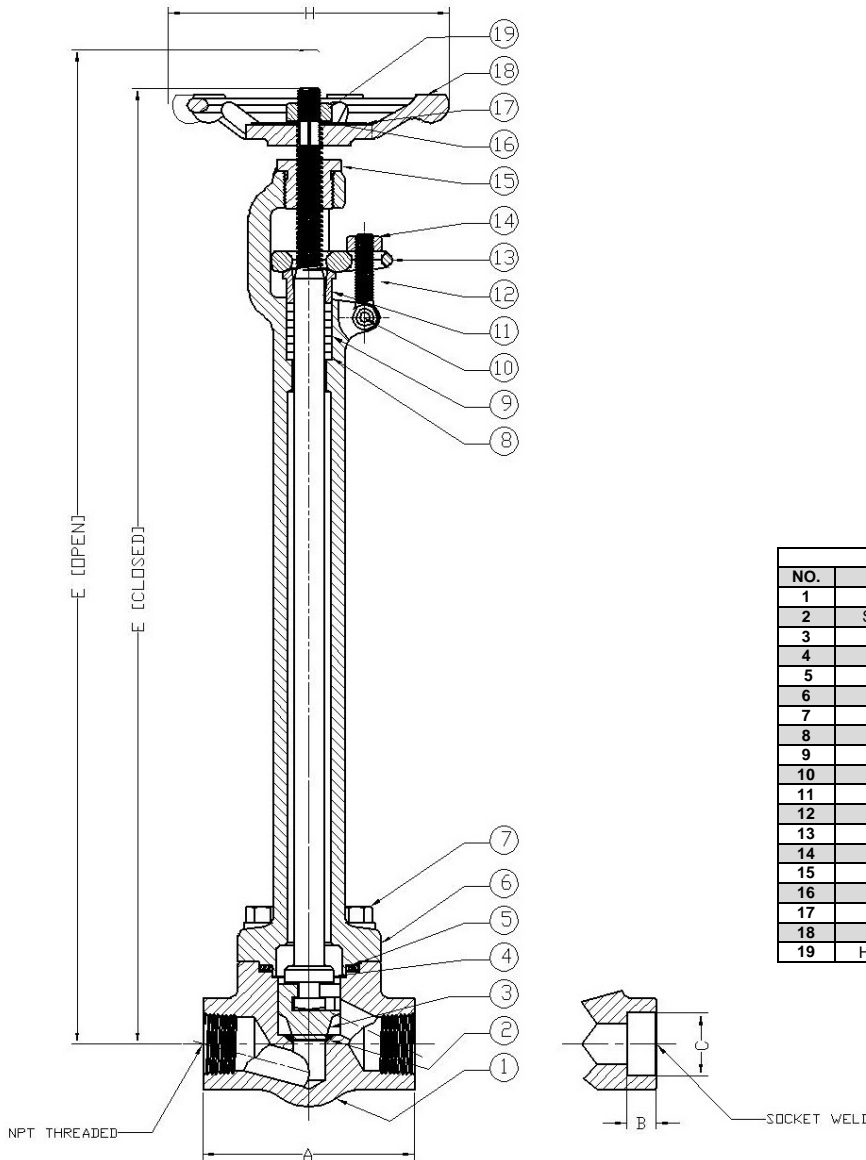

502 series with cryogenic extended bonnet.
Please refer to the Options section of the
Figure Number Chart for applicable code.

STANDARDS

DESIGN:

API 602
MSS SP-118
ASME B16.34

TESTING:

API 598

PRESSURE CLASS:

NPT & SW - 800

CONNECTIONS:

NPT - ASME B1.20.1
SW - ASME B16.11

MATERIAL LIST		
NO.	Part Name	SPECIFICATION
1	Body	ASTM A182 Gr. F316/F316L
2	Seat (Integral)	CoCr-A
3	Disc	ASTM A276 Gr. 316
4	Stem	ASTM A276 Gr. 316
5	Gasket	Spiral Wound 316/Graphite
6	Bonnet	ASTM A182 Gr. F316/F316L
7	Body Bolt	ASTM A193 Gr. B8M
8	Wiper Rings	Braided Graphite
9	Packing	Die Formed Graphite
10	Eyebolt Pin	ASTM A276 Gr. 316
11	Gland	ASTM A276 Gr. 316
12	Eyebolt	ASTM A193 Gr. B8M
13	Gland Plate	ASTM A182 Gr. F316
14	Gland Nut	ASTM A194 Gr. 8M
15	Op Nut	ASTM A276 Gr. 316
16	Washer	ASTM A276 Gr. 410
17	Nameplate	Aluminum
18	Handwheel	A197
19	Handwheel Nut	A194-8

DIMENSIONS AND WEIGHTS								
SIZE		A	B (Min)	C	D (Min)	EO	EC	H
1/2	Inch	3.11	0.37	0.87	0.37	17.2	16.7	4.72
	mm	79.0	9.50	22.0	9.50	437.0	425.0	120.0
3/4	Inch	3.62	0.49	1.08	0.49	17.2	16.7	4.72
	mm	92.0	12.5	27.4	12.5	437.0	425.0	120.0
1	Inch	4.37	0.49	1.34	0.71	18.5	17.9	6.30
	mm	111.0	12.5	34.1	18.0	471.0	455.0	160.0
1-1/2	Inch	5.98	0.49	1.93	1.12	19.9	19.1	8.66
	mm	152.0	12.5	49.0	28.5	506.0	484.0	220.0
2	Inch	6.77	0.63	2.42	1.44	21.4	20.3	8.66
	mm	172.0	16.0	61.5	36.5	544.0	516.0	220.0

Bellows Seal Gate Valve Forged Steel

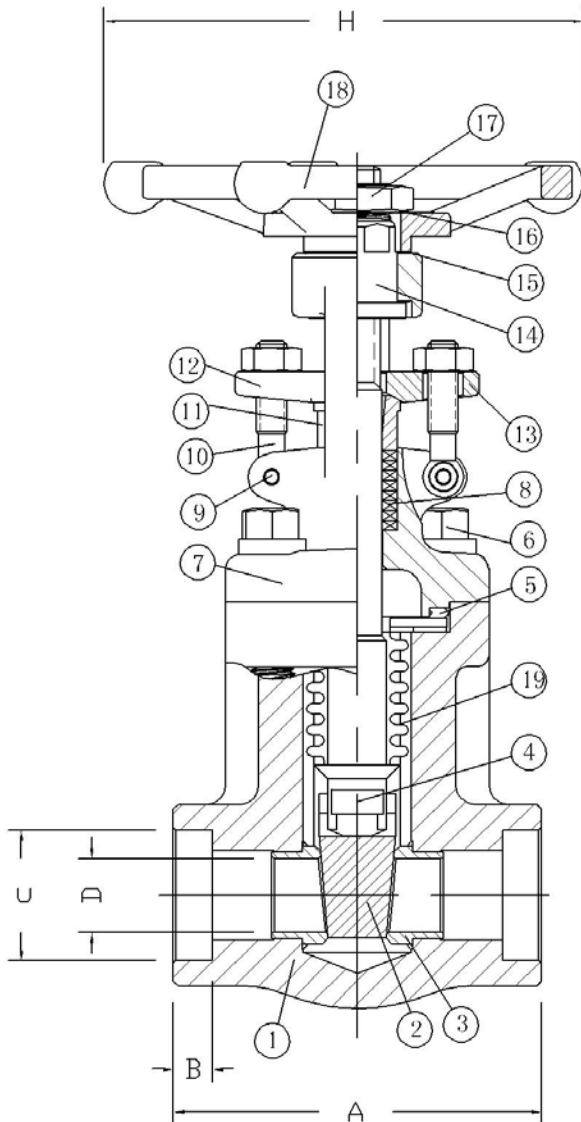

501 series with Bellows Seal.
Please refer to the Options section of the Figure Number Chart for applicable code.

STANDARDS

DESIGN:

API 602
ASME B16.34

TESTING:

API 598

PRESSURE CLASS:

NPT & SW – 800

CONNECTIONS:

NPT – ASME B1.20.1
SW – ASME B16.11

MATERIAL LIST		
NO.	Part Name	SPECIFICATION
1	Body	ASTM A105N
2	Gate	ASTM A276 Gr. 410/CoCr-A
3	Seat Ring	ASTM A276 Gr. 410/CoCr-A
4	Stem	ASTM A276 Gr. 410
5	Gasket	Spiral Wound 316/Graphite
6	Body Bolt	ASTM A193 Gr. B7
7	Bonnet	ASTM A05N
8	Packing	Graphite
9	Eyebolt Pin	ASTM A276 Gr. 304
10	Eyebolt	ASTM A193 Gr. B7
11	Gland	ASTM A276 Gr. 410
12	Gland Plate	ASTM A105
13	Gland Nut	ASTM A194 Gr. 2H
14	Op Nut	ASTM A276 Gr. 410
15	Washer	ASTM A276 Gr. 410
16	Washer	ASTM A276 Gr. 410
17	Handwheel Nut	A194-8
18	Handwheel	A197
19	Bellows	F316L

Contact factory for optional materials.

DIMENSIONS AND WEIGHTS						
SIZE		A	B (Min)	C	D (Min)	H
1/2	Inch	3.11	0.37	0.87	0.51	3.94
	mm	79.0	9.50	22.0	13.0	100.0
3/4	Inch	3.62	0.49	1.08	0.51	3.94
	mm	92.0	12.5	27.4	13.0	100.0
1	Inch	4.37	0.49	1.34	0.71	4.72
	mm	111.0	12.5	34.1	18.0	120.0
1-1/2	Inch	4.72	0.49	1.93	1.14	6.30
	mm	120.0	12.5	49.0	29.0	160.0
2	Inch	5.51	0.63	2.42	1.44	8.66
	mm	140.0	16.0	61.5	36.5	220.0

Bellows Seal Globe Valve Forged Steel

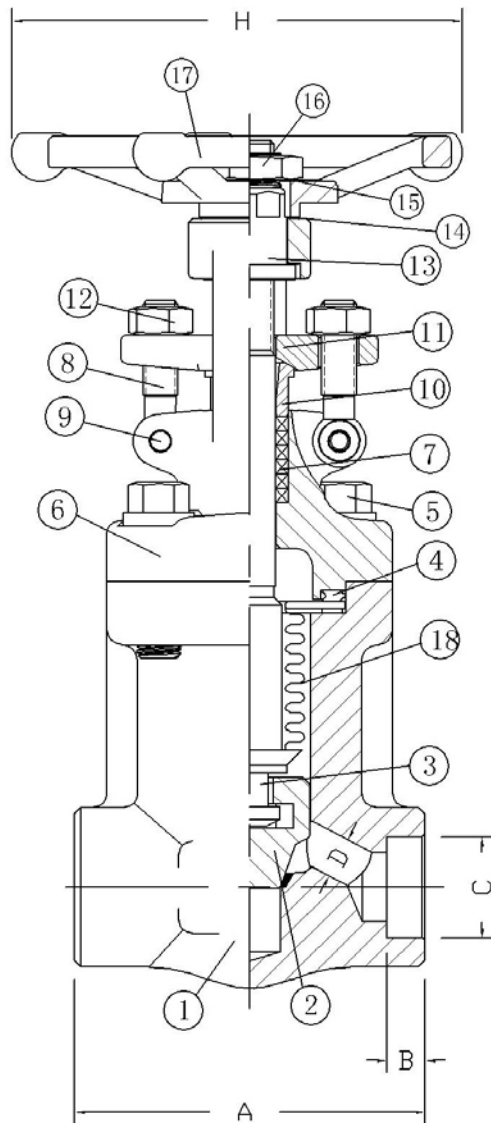

502 series with Bellows Seal.
Please refer to the Options section of the
Figure Number Chart for applicable code.

STANDARDS

DESIGN:

API 602
MSS SP-118
ASME B16.34

TESTING:

API 598

PRESSURE CLASS:

NPT & SW – 800

CONNECTIONS:

NPT – ASME B1.20.1
SW - ASME B16.11

MATERIAL LIST		
NO.	Part Name	SPECIFICATION
1	Body/Seat	ASTM A105N/CoCr-A
2	Disc	ASTM A276 Gr. 410
3	Stem	ASTM A276 Gr. 316
4	Gasket	Spiral Wound 304/Graphite
5	Body Bolt	ASTM A193 Gr. B7
6	Bonnet	ASTM A105N
7	Packing	Die Formed Graphite
8	Eyebolt	ASTM A193 Gr. B8
9	Eyebolt Pin	ASTM A276 Gr. 304
10	Gland	ASTM A276 Gr. 410
11	Gland Plate	ASTM A105
12	Gland Nut	ASTM A194 Gr. 2H
13	Op Nut	ASTM A276 Gr. 410
14	Washer	ASTM A276 Gr. 410
15	Nameplate	Aluminum
16	Handwheel Nut	A193 2H
17	Handwheel	A197
18	Bellows	F316L

Contact factory for optional materials.

DIMENSIONS AND WEIGHTS						
SIZE		A	B(Min)	C	D (Min)	H
1/2	Inch	3.11	0.37	0.87	0.37	3.94
	mm	79.0	9.50	22.0	9.50	100.0
3/4	Inch	3.62	0.49	1.07	0.49	3.94
	mm	92.0	12.5	27.4	12.5	100.0
1	Inch	4.37	0.49	1.34	0.69	4.72
	mm	111.0	12.5	34.1	17.5	120.0
1-1/2	Inch	5.98	0.49	1.92	1.12	6.30
	mm	152.0	12.5	49.0	28.5	160.0
2	Inch	6.77	0.63	2.41	1.44	7.50
	mm	172.0	16.0	61.5	36.5	220.0

Ball Check Valve Standard Port, Bolted Bonnet Forged Steel

530 SERIES

STANDARDS

DESIGN:

API 602
MSS SP-118
ASME B16.34

TESTING:

API 598

PRESSURE CLASS:

NPT & SW – 800
FLANGED – 150,300,600

CONNECTIONS:

NPT – ASME B1.20.1
SW - ASME B16.11
FLANGED – ASME B16.5
ASME B16.10

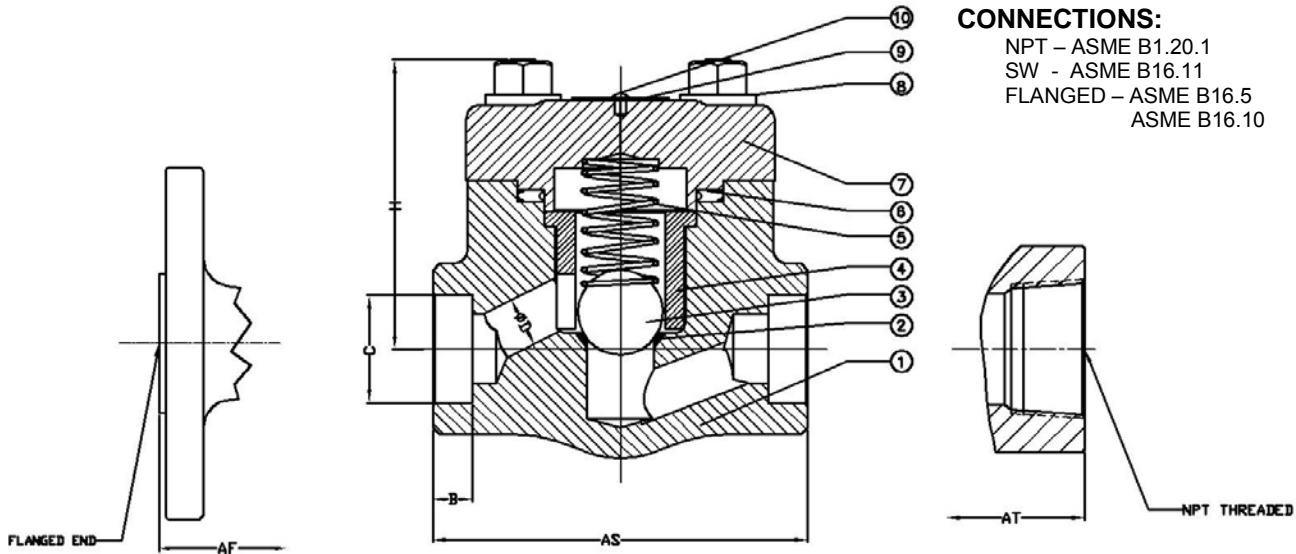

MATERIAL LIST								
NO.	Part Name	A105	LF2	F5	F9	F11	F22	F316/F316L
1	Body	A105N	A350-LF2	A182-F5	A182-F9	A182-F11	A182-F22	A182-F316/F316L
2	Seat Ring	CoCr-A						316/CoCr-A
3	Ball	A276-440C						
4	Guide	A276-410						
5	Spring	A276-316						
6	Gasket	Spiral Wound 304/Graphite						316/Graphite
7	Bonnet	A105N	A350-LF2	A182-F5	A182-F9	A182-F11	A182-F22	A182-F316/F316L
8	Body Bolt	A193-B7	A320-L7	A193-B16				A193-B8M
9	Nameplate	Aluminum						
10	Rivet	A276-410						

DIMENSIONS AND WEIGHTS

SIZE		AT	AS	AF-150	AF-300	AF-600	B(Min)	C	D (Min)	H	WGT.			
											150	300	600	800
1/2	Inch	3.11	3.11	4.25	5.98	6.50	0.37	0.87	0.37	2.28	7.94	8.16	8.82	3.31
	mm	79.0	79.0	108.0	152.0	165.0	9.50	22.0	9.50	58.0	3.60	3.70	4.00	1.50
3/4	Inch	3.62	3.62	4.61	7.01	7.48	0.49	1.08	0.49	2.28	10.1	10.6	12.8	3.75
	mm	92.0	92.0	117.0	178.0	190.0	12.5	27.4	12.5	58.0	4.60	4.80	5.80	1.70
1	Inch	4.37	4.37	5.00	8.00	8.50	0.49	1.34	0.69	2.95	18.8	19.4	20.9	7.28
	mm	111.0	111.0	127.0	203.0	216.0	12.5	34.1	17.5	75.0	8.50	8.80	9.50	3.30
1-1/4	Inch	4.72	4.72	5.51	8.50	9.02	0.49	1.69	0.93	3.31	20.3	21.2	22.9	9.26
	mm	120.0	120.0	140.0	216.0	229.0	12.5	42.9	23.5	84.0	9.20	9.60	10.4	4.20
1-1/2	Inch	5.98	5.98	6.50	9.02	9.49	0.49	1.93	1.12	3.82	27.6	30.2	34.4	9.26
	mm	152.0	152.0	165.0	229.0	241.0	12.5	49.0	28.5	97.0	12.5	13.7	15.6	4.20
2	Inch	6.77	6.77	7.99	10.51	11.5	0.63	2.42	1.44	4.53	32.6	39.2	54.0	23.2
	mm	172.0	172.0	203.0	267.0	292.0	16.0	61.5	36.5	115.0	14.8	17.8	24.5	10.5

(713) 673-2073 – Fax (713) 673-4641 - Toll Free (866) GO-BERIC (462-3742)

www.bericvalves.com

Ball Check Valve Full Port, Bolted Bonnet Forged Steel

531 SERIES

STANDARDS

DESIGN:

API 602
MSS SP-118
ASME B16.34

TESTING:

API 598

PRESSURE CLASS:

NPT & SW – 800
FLANGED – 150,300,600

CONNECTIONS:

NPT – ASME B1.20.1
SW - ASME B16.11
FLANGED – ASME B16.5
ASME B16.10

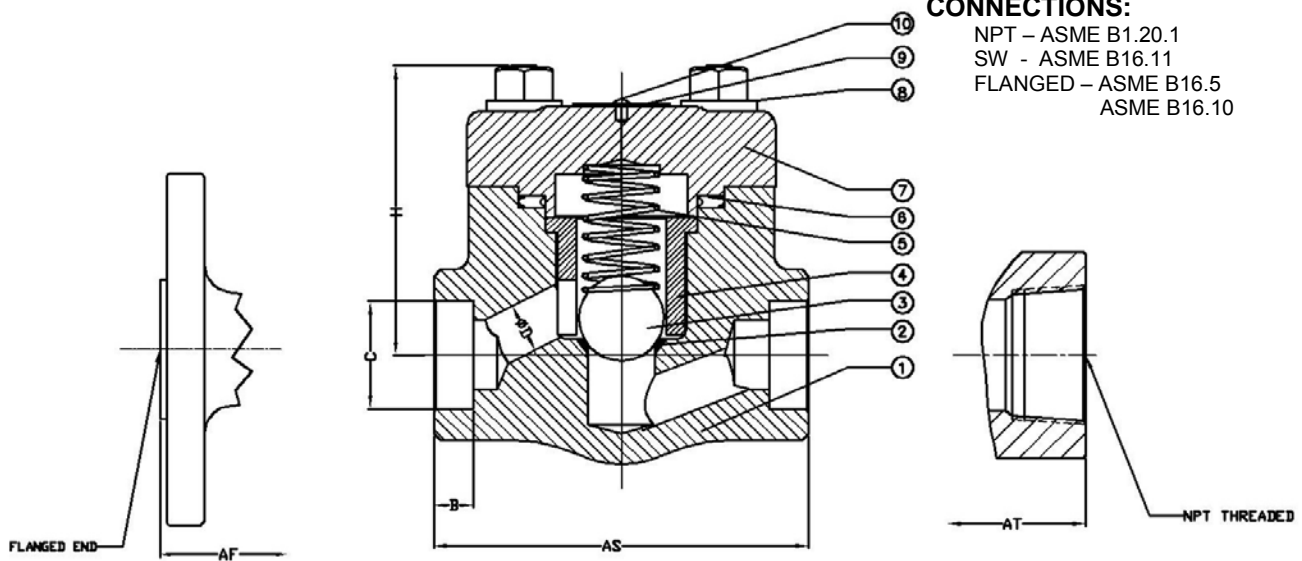

MATERIAL LIST								
NO.	Part Name	A105	LF2	F5	F9	F11	F22	F316/F316L
1	Body	A105N	A350-LF2	A182-F5	A182-F9	A182-F11	A182-F22	A182-F316/F316L
2	Seat Ring	CoCr-A						316/CoCr-A
3	Ball	A276-440C						
4	Guide	A276-410						
5	Spring	A276-316						
6	Gasket	Spiral Wound 304/Graphite						316/Graphite
7	Bonnet	A105N	A350-LF2	A182-F5	A182-F9	A182-F11	A182-F22	A182-F316/F316L
8	Body Bolt	A193-B7	A320-L7	A193-B16				A193-B8M
9	Nameplate	Aluminum						
10	Rivet	A276-410						

DIMENSIONS AND WEIGHTS

SIZE		AT	AS	AF-150	AF-300	AF-600	B(Min)	C	D (Min)	H	WGT.			
											150	300	600	800
1/2	Inch	3.11	3.62	4.25	5.98	6.50	0.37	0.87	0.49	2.28	10.1	10.6	12.8	3.75
	mm	79.0	92.0	108.0	152.0	165.0	9.50	22.0	12.5	58.0	4.60	4.80	5.80	1.70
3/4	Inch	4.37	4.37	4.60	7.01	7.48	0.49	1.08	0.69	3.07	18.8	19.4	20.9	7.28
	mm	111.0	111.0	117.0	178.0	190.0	12.5	27.4	17.5	78.0	8.50	8.80	9.50	3.30
1	Inch	4.72	4.72	5.00	7.99	8.50	0.49	1.34	0.89	3.31	20.3	21.2	22.9	9.26
	mm	120.0	120.0	127.0	203.0	216.0	12.5	34.1	22.5	84.0	9.20	9.60	10.4	4.20
1-1/4	Inch	5.98	5.98	5.51	8.50	9.02	0.49	1.69	1.12	3.82	27.6	30.2	34.4	9.26
	mm	152.0	152.0	140.0	216.0	229.0	12.5	42.9	28.5	97.0	12.5	13.7	15.6	5.30
1-1/2	Inch	6.77	6.77	6.50	9.02	9.49	0.49	1.93	1.40	4.53	32.6	39.2	54.0	23.2
	mm	172.0	172.0	165.0	229.0	241.0	12.5	49.0	35.5	115.0	14.8	17.8	24.5	8.00
2	Inch	8.66	7.87	7.99	10.5	11.51	0.63	2.41	1.75	5.20	37.0	43.7	58.4	27.6
	mm	220.0	200.0	203.0	267.0	292.0	16.0	61.5	44.5	132.0	16.8	19.8	26.5	12.5

(713) 673-2073 – Fax (713) 673-4641 - Toll Free (866) GO-BERIC (462-3742)

www.bericvalves.com

Ball Check Valve Standard Port, Welded Bonnet Forged Steel

532 SERIES

STANDARDS

DESIGN:

API 602
MSS SP-118
ASME B16.34

TESTING:

API 598

PRESSURE CLASS:

NPT & SW – 800
FLANGED – 150,300,600

CONNECTIONS:

NPT – ASME B1.20.1
SW - ASME B16.11
FLANGED – ASME B16.5
ASME B16.10

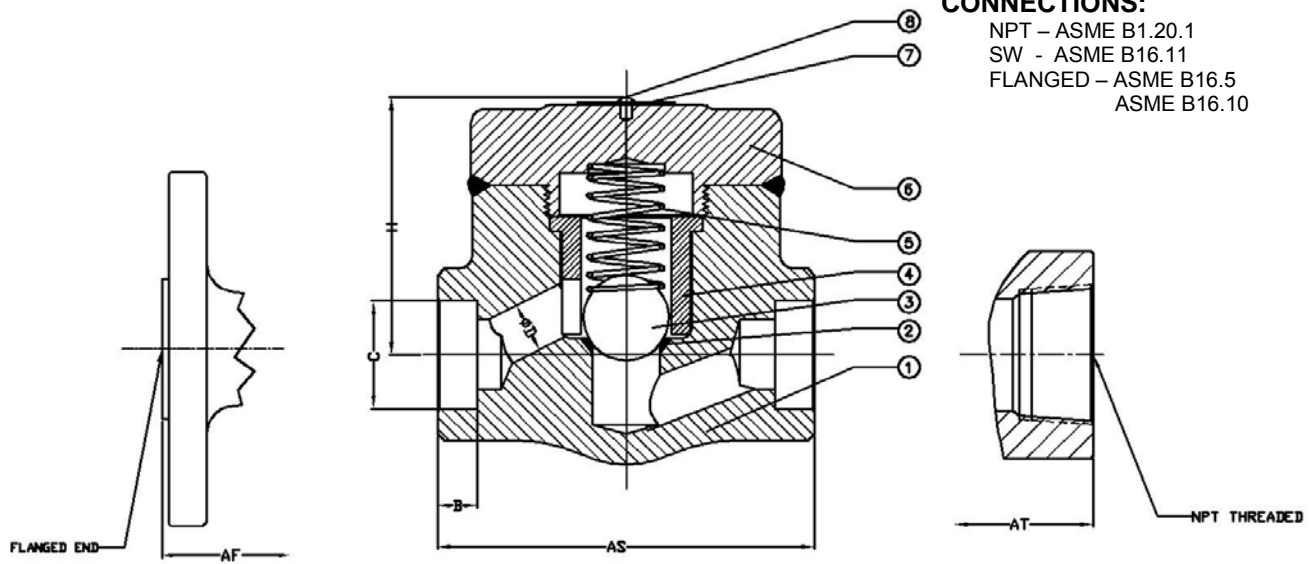

MATERIAL LIST								
NO.	Part Name	A105	LF2	F5	F9	F11	F22	F316/F316L
1	Body	A105N	A350-LF2	A182-F5	A182-F9	A182-F11	A182-F22	A182-F316/F316L
2	Seat Ring	CoCr-A						316/CoCr-A
3	Ball	A276-440C						
4	Guide	A276-410						
5	Spring	A276-316						
6	Gasket	Spiral Wound 304/Graphite						316/Graphite
7	Bonnet	A105N	A350-LF2	A182-F5	A182-F9	A182-F11	A182-F22	A182-F316/F316L
8	Body Bolt	A193-B7	A320-L7	A193-B16				A193-B8M
9	Nameplate	Aluminum						
10	Rivet	A276-410						

DIMENSIONS AND WEIGHTS

SIZE		AT	AS	AF-150	AF-300	AF-600	B(Min)	C	D (Min)	H	WGT.			
											150	300	600	800
1/2	Inch	3.11	3.11	4.25	5.98	6.50	0.37	0.87	0.39	1.97	7.94	8.16	8.82	3.31
	mm	79.0	79.0	108.0	152.0	165.0	9.50	22.0	9.50	50.0	3.60	3.70	4.00	1.50
3/4	Inch	3.62	3.62	4.61	7.01	7.48	0.49	1.08	0.49	2.05	10.1	10.6	12.8	3.75
	mm	92.0	92.0	117.0	178.0	190.0	12.5	27.4	12.5	52.0	4.60	4.80	5.80	1.70
1	Inch	4.37	4.37	5.00	7.99	8.50	0.49	1.34	0.69	2.76	18.8	19.4	20.9	7.28
	mm	111.0	111.0	127.0	203.0	216.0	12.5	34.1	17.5	70.0	8.50	8.80	9.50	3.30
1-1/4	Inch	4.72	4.72	5.51	8.50	9.02	0.49	1.69	0.89	3.23	20.3	21.2	22.9	9.26
	mm	120.0	120.0	140.0	216.0	229.0	12.5	42.9	22.5	82.0	9.20	9.60	10.4	4.20
1-1/2	Inch	5.98	5.98	6.50	9.02	9.49	0.49	1.93	1.12	3.31	27.6	30.2	34.4	9.26
	mm	152.0	152.0	165.0	229.0	241.0	12.5	49.0	28.5	96.0	12.5	13.7	15.6	4.20
2	Inch	6.77	6.77	7.99	10.5	11.5	0.63	2.42	1.44	4.33	32.6	39.2	54.0	23.2
	mm	172.0	172.0	203.0	267.0	292.0	16.0	61.5	36.5	110.0	14.8	17.8	24.5	10.5

(713) 673-2073 – Fax (713) 673-4641 - Toll Free (866) GO-BERIC (462-3742)

www.bericvalves.com

Ball Check Valve Full Port, Welded Bonnet Forged Steel

533 SERIES

STANDARDS

DESIGN:

API 602
MSS SP-118
ASME B16.34

TESTING:

API 598

PRESSURE CLASS:

NPT & SW – 800
FLANGED – 150,300,600

CONNECTIONS:

NPT – ASME B1.20.1
SW - ASME B16.11
FLANGED – ASME B16.5
ASME B16.10

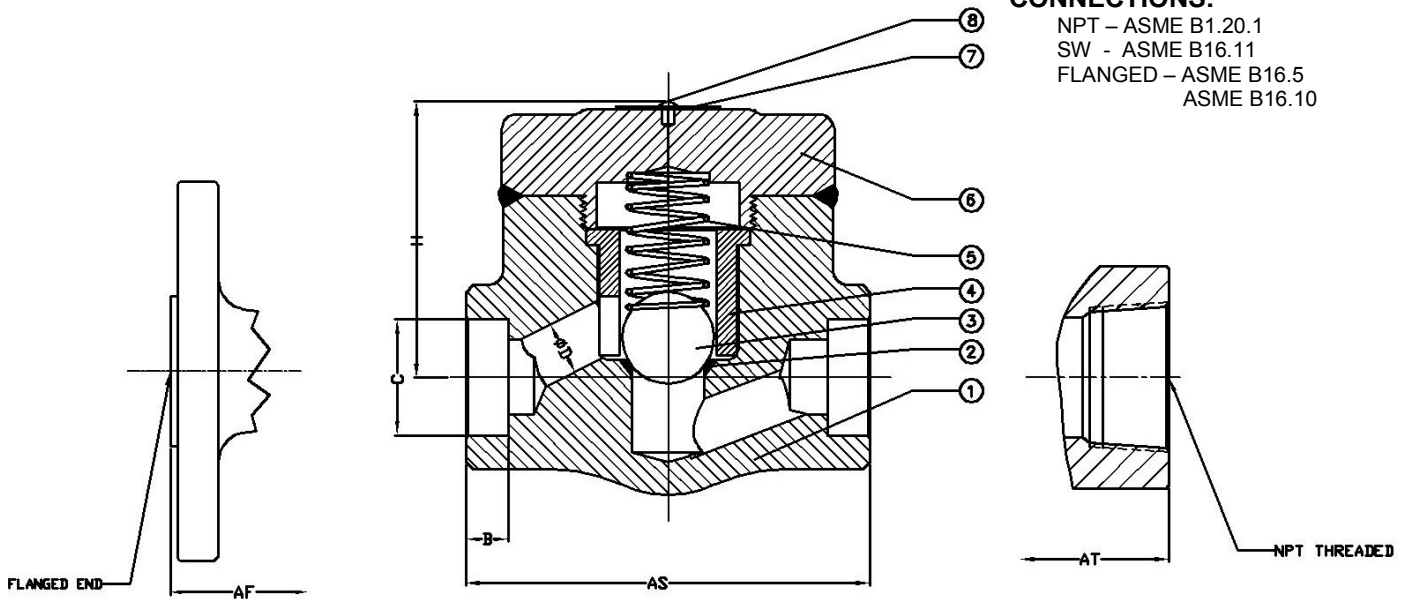

MATERIAL LIST								
NO.	Part Name	A105	LF2	F5	F9	F11	F22	F316/F316L
1	Body	A105N	A350-LF2	A182-F5	A182-F9	A182-F11	A182-F22	A182-F316/F316L
2	Seat Ring	CoCr-A						316/CoCr-A
3	Ball	A276-440C						
4	Guide	A276-410						
5	Spring	A276-316						
6	Bonnet	A105N	A350-LF2	A182-F5	A182-F9	A182-F11	A182-F22	A182-F316/F316L
7	Nameplate	Aluminum						
8	Rivet	A276-410						

DIMENSIONS AND WEIGHTS

SIZE		AT	AS	AF-150	AF-300	AF-600	B(Min)	C	D (Min)	H	WGT.			
											150	300	600	800
1/2	Inch	3.11	3.62	4.25	5.98	6.50	0.37	0.87	0.49	1.97	10.1	10.6	12.8	3.75
	mm	79.0	92.0	108.0	152.0	165.0	9.50	22.0	12.5	50.0	4.60	4.80	5.80	1.70
3/4	Inch	4.37	4.37	4.61	7.01	7.48	0.49	1.08	0.69	2.76	18.8	19.4	20.9	7.28
	mm	111.0	111.0	117.0	178.0	190.0	12.5	27.4	17.5	70.0	8.50	8.80	9.50	3.30
1	Inch	4.72	4.72	5.00	7.99	8.50	0.49	1.34	0.89	3.23	20.3	21.2	22.9	9.26
	mm	120.0	120.0	127.0	203.0	216.0	12.5	34.1	22.5	82.0	9.20	9.60	10.4	4.20
1-1/4	Inch	5.98	5.98	5.51	8.50	9.02	0.49	1.69	1.12	3.78	27.6	30.2	34.4	9.26
	mm	152.0	152.0	140.0	216.0	229.0	12.5	42.9	28.5	96.0	12.5	13.7	15.6	4.20
1-1/2	Inch	6.77	6.77	6.50	9.02	9.49	0.49	1.93	1.40	4.33	32.6	39.2	54.0	23.2
	mm	172.0	172.0	165.0	229.0	241.0	12.5	49.0	35.5	110.0	14.8	17.8	24.5	10.5
2	Inch	8.66	7.87	7.99	10.5	11.5	0.63	2.42	1.75	4.92	37.0	43.7	58.4	27.6
	mm	220.0	200.0	203.0	267.0	292.0	16.0	61.5	44.5	125.0	16.8	19.8	26.5	12.5

(713) 673-2073 – Fax (713) 673-4641 - Toll Free (866) GO-BERIC (462-3742)

www.bericvalves.com